

INSTALLATION INSTRUCTIONS

Thermistor Kit (P/N 560005495) on Pinnacle FCB Post-Mix Dispensers

SAFETY INSTRUCTIONS

 **WARNING:**

Before starting installation, read and understand all safety label and warnings on the machine. Also review and understand all safety instructions in the owners, installation and service manuals.

Failure to comply could result in serious injury, death or damage to the equipment.

QUALIFIED SERVICE PERSONNEL

 **WARNING:**

Only trained and certified electrical, plumbing and refrigeration technicians should service this unit.

All wiring and plumbing must conform to national and local codes. Failure to comply could result in serious injury, death or equipment damage.

SAFETY PRECAUTIONS

This unit has been specifically designed to provide protection against personal injury. To ensure continued protection observe the following:

 **WARNING:**

Disconnect power to the unit before servicing. Follow all lock out/tag out procedures established by the user. Verify all power is off to the unit before performing any work.

Failure to comply could result in serious injury, death or damage to the equipment.

 **CAUTION:**

Always be sure to keep area around the unit clean and free of clutter.

Failure to keep this area clean may result in injury or equipment damage.

INSTALLATION INSTRUCTIONS

Read and understand these instructions thoroughly before installing this kit. Retain these instructions as part of your equipment manual.

NOTE: This Thermistor Kit (P/N 560005495) may be installed on the 2 flavor Pinnacle FCB Post-Mix Dispenser models and on the 4 flavor Pinnacle FCB Post-Mix Dispenser models.

NOTE: The following instructions outline the procedure to install the thermistor kit on the refrigeration system of the Pinnacle Dispenser. Two size clips are needed for the different size copper tubes, but the same thermistor is used for all applications. In each application, it is necessary the thermistor is attached to the refrigeration copper tube indentations as well as possible to get the best performance out of the Pinnacle unit.

1. Remove side panels from unit.
2. Locate faulty sensor.
3. Remove fire retardant tape.
4. Remove faulty sensor and unplug from wire harness.
5. From diagram shown install new sensor as shown.
6. Install panels and restore electrical power, then check for proper operation.

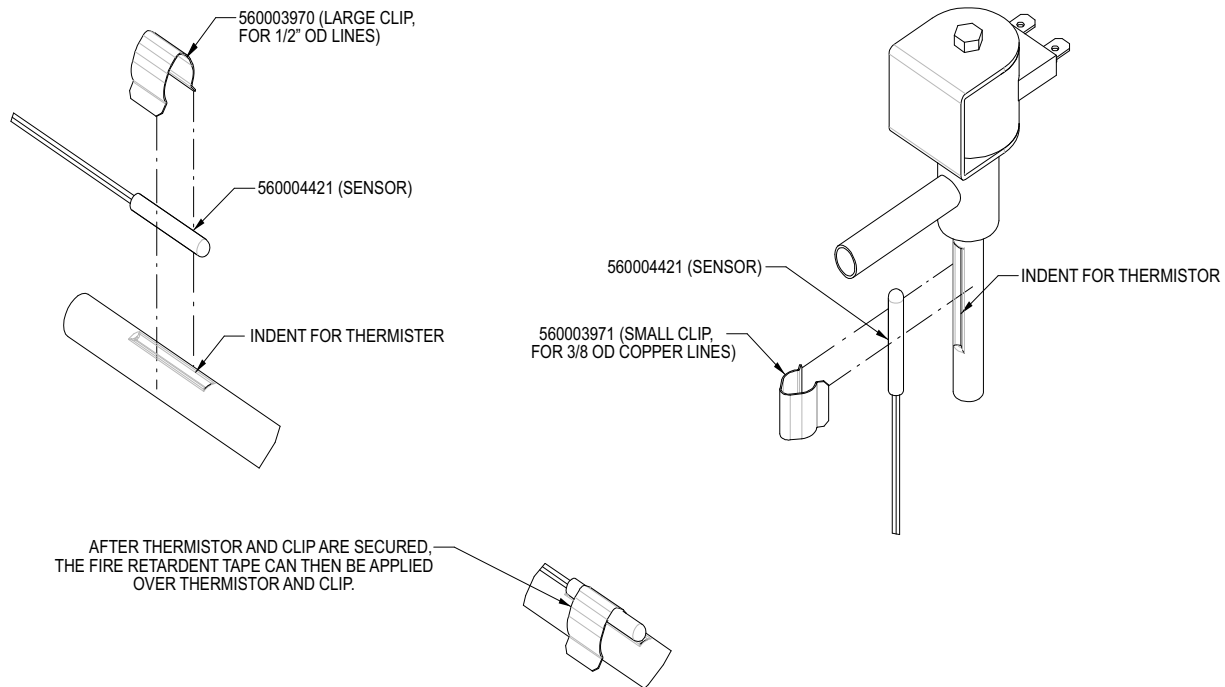

Figure 1.