

# INSTALLATION INSTRUCTIONS

## RETROFIT UPPER FRONT SERVICE ACCESS PANEL AND ELECTRICAL CONTROL BOX KIT (P/N 629084701)

For Quick Trip ED300 Models (P/N 621024444Q0400 and P/N 621024444Q0401)

Item No.	Part Number	Name	Qty.
1	620031609	Service Access Panel	1
2	620032203	Upper Front Panel	1
3	620032202	Right-Side Panel	1
4	620032201	Left-Side Panel	1
5	620308001	Electrical Control Box Ass'y	1
6	70250	1/4--20 X 1/2-inch Lg Screw	2
7	70060	1/4 Lockwasher	2
8	70171	#8--32 X 3/8-inch Lg Screw	12
9	620031607	Control Box Cover	1
10	70226	#10 X 3/4-inch Sheetmetal Screw	4
11	92067	Label, Agitation Timer	1
12	620912401	Label, Wiring Diagram	1
13	50705	Cable Tie	10
14	91956	Label, Warning Electric Shock	1
15	91546	Label, Ice Gate Restrictor	1
16	620032301	Drilling Template	1
17	620912701	Installation Instructions	1



### WARNING:

Disconnect power to the unit before servicing. Follow all lock out/tag out procedures established by the user. Verify all power is off to the unit before performing any work.

**Failure to comply could result in serious injury, death or damage to the equipment.**

Perform the following procedure (Refer to Figure 1):

1. Remove the upper front panel by lifting up on both the right and left sides to disengage the panel brackets from the slots in the dispenser cabinet. Tilt the front panel forward from the top and lift off. Discard the panel.
2. To remove the electrical control box, it will first be necessary to disconnect the following wire harnesses:
  - A. Remove the lower front panel (2 screws) for access to the agitator motor and dispense switch harnesses.
  - B. Lower the white control box cover by rotating the two plastic clips at the top of the cover upward so that the cover can be swung down for access to the controls and wiring.
  - C. Disconnect the two black wires for the agitator motor heaters at both terminal strips and remove from the control box. These leads will be reconnected after the new control box is installed.
  - D. Disconnect the green ground wire from the left side control box bracket and discard.
  - E. Remove the three top covers (and discard) from the beverage faucet panel to expose the wiring for the 24-volt beverage circuit. Locate the two yellow leads from each beverage transformer and disconnect the quick-connect terminal housings in the beverage circuit. The beverage transformers on the new control box will be connected to these same points in the beverage circuit.
  - F. Disconnect the agitator motor harness at the 5-circuit quick-connect housing at each motor.

- G. Disconnect each dispense switch harness from the terminals at the switch.
  - H. Disconnect each gate solenoid harness at the 3-circuit quick-connect housing at each solenoid.
3. The control box can now be removed by drilling out the two top rivets located on each of the left and right side mounting brackets. Before proceeding with the drilling operation, make certain that all the harness connections in step 2 have been disconnected and are removed (hanging “free”) from the unit. This allows the control box to be easily removed once the pop rivets have been drilled out. Discard the “old” control box and white cover.
  4. Remove the left and right side control box mounting brackets by drilling out the four pop rivets that secure each bracket to the dispenser cabinet and discard.
  5. Install the new electrical control box assembly by first locating and drilling (2) .312 diameter holes in the agitator motor mounting bracket. Use the drilling template supplied in the kit to locate these holes. It will be necessary to first remove both the left and right ice chute covers (snap-fit) and ice chutes (8 nuts). Next, lower the beverage faucet panel (4 screws) to provide access to the motor mounting bracket. Locate the template as shown in Figure 2A. It is suggested that the template be “clamped” to the motor mounting bracket to secure it during the drilling operation. (Refer to Figure 2 and Figure 3)

 **CAUTION:**

Use care when drilling into the agitator motor mounting bracket to avoid puncturing the ice storage hopper. Use of a drill depth-limiting “stop” is recommended. The motor bracket is 14 gauge (.075-inch thick) galvanized steel.

6. Slide the control box assembly mounting bracket behind the motor mounting bracket. Secure the control box assembly to the agitator motor mounting bracket with (2) 1/4--20 screws and lock washers. Secure the beverage faucet panel in position on the cabinet. Replace the ice chutes.
7. Connect and route the harnesses to their mating connections as described in step 2. Use plastic cable ties as necessary to secure the wiring away from moving parts, sharp edges, interference with panel removal, etc. Refer to the wiring diagram included with this kit for aid in hooking up the control box harnesses.

 **WARNING:**

Electrical power is supplied to unit before step 8 in this installation. Be careful to avoid contact with all electrical components and wiring and hazardous moving parts-agitator motor and gate solenoid mechanism.

8. Before proceeding, verify that the electrical connections are correct by plugging in the supply cord to a 115 volt, 15 amp outlet. Check that the automatic agitation timer energizes the agitator motor when the supply cord is first plugged in. Check that the left side agitator motor and gate solenoid are energized (agitator turns and gate opens) when the left side dispense switch push button is depressed. Repeat this check for the right side dispensing components. Check that the beverage valves are operational. If there are problems with any of these checks, refer to the wiring diagram to troubleshoot the wiring connections. After verifying that the unit is operating properly, **DISCONNECT ELECTRICAL POWER FOR THE REMAINING INSTALLATION STEPS.**
9. Replace the lower front panel. Install the control box cover. (Refer to Figure 4)
10. Install the upper right and left side panels to the cabinet front flanges with #10 sheet metal screws provided in the kit. The top flange of the side panels will be flush with the cabinet top flange when the mounting holes in both the side panel and the cabinet flange are aligned.
11. Install the upper front panel to the right and left side panels with (4) #8--32 machine screws.
12. Locate the wiring diagram, gate restrictor, and agitation timer labels on the rear of the service access panel.
13. Install the service access panel to the upper front panel and side panels with (6) #8--32 screws. Note that the (4) tabs on the bottom of the service panel fit into corresponding slots in the beverage valve panel.
14. The unit is now ready for operation.

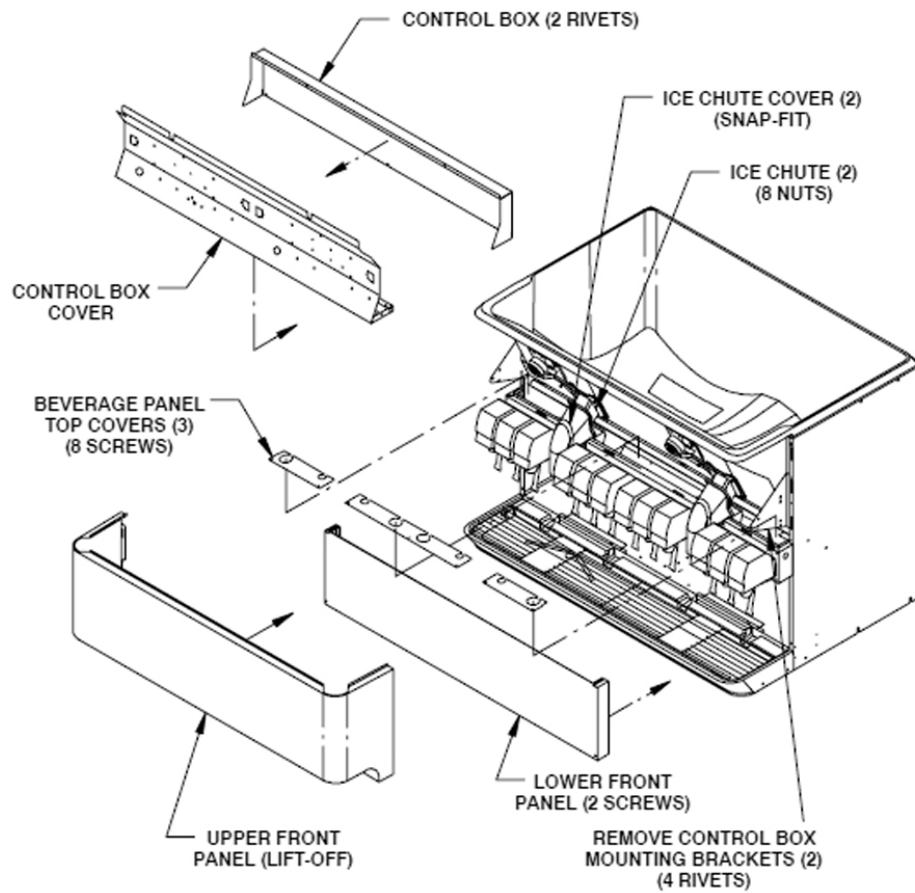

**Figure 1. Panel/Electrical Box Removal**

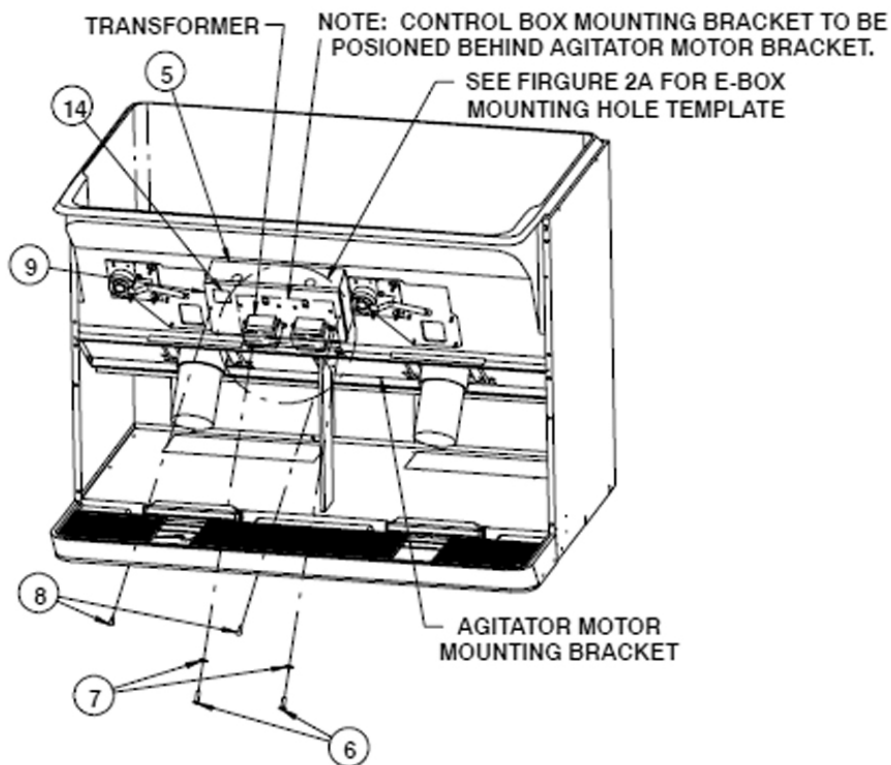

**Figure 2.**

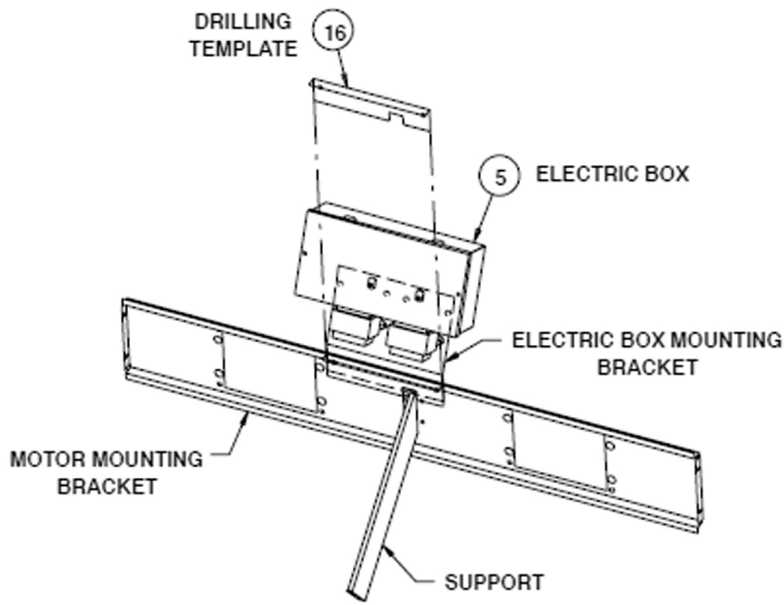

Figure 3.

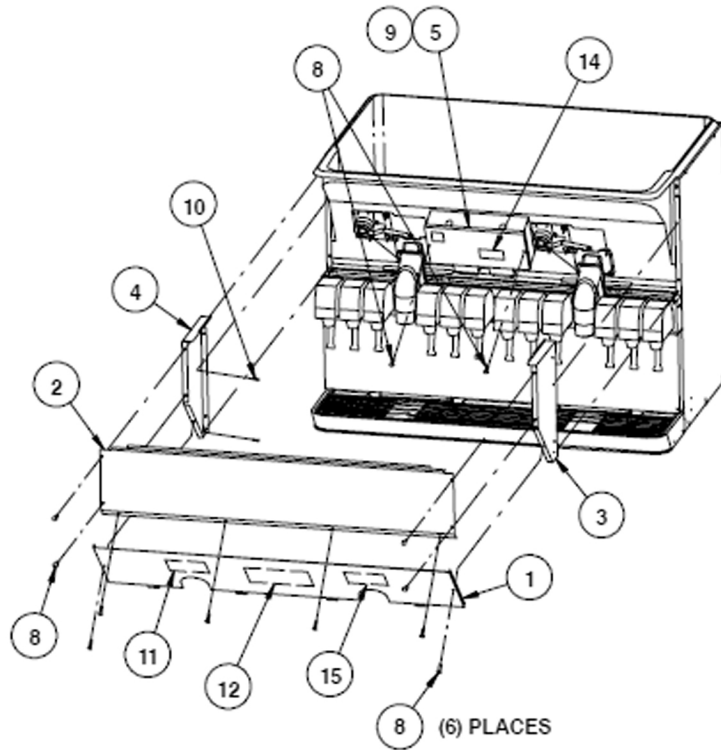

Figure 4.