

# INSTALLATION INSTRUCTIONS

## Dual-lighted Merchandiser Kit

**NOTE:** P/N 629080501 (gray) and P/N 629080502 (black) on two enduro-150 6-valve ice/beverage dispensers

### SAFETY INSTRUCTIONS

 **WARNING:**

Before starting installation, read and understand all safety label and warnings on the machine. Also review and understand all safety instructions in the owners, installation and service manuals.

**Failure to comply could result in serious injury, death or damage to the equipment.**

### QUALIFIED SERVICE PERSONNEL

 **WARNING:**

Only trained and certified electrical, plumbing and refrigeration technicians should service this unit.

**All wiring and plumbing must conform to national and local codes. Failure to comply could result in serious injury, death or equipment damage.**

### SAFETY PRECAUTIONS

This unit has been specifically designed to provide protection against personal injury. To ensure continued protection observe the following:

 **WARNING:**

Disconnect power to the unit before servicing. Follow all lock out/tag out procedures established by the user. Verify all power is off to the unit before performing any work.

**Failure to comply could result in serious injury, death or damage to the equipment.**

 **CAUTION:**

Always be sure to keep area around the unit clean and free of clutter.

**Failure to keep this area clean may result in injury or equipment damage.**

## INSTRUCTIONS

Read and understand these instructions thoroughly before installing this kit. Retain these instructions as part of your equipment manual.

**NOTE: Only qualified personnel should install this kit.**

**Table 1. Loose Shipped Parts**

Item No.	Part No.	Name	Qty.
1	52981	Dual Merchandiser, Gray	1
	52980	Dual Merchandiser, Black	1
2	29674	Dual Lower Panel	1
3	29677	Rear Mounting Plate	1
4	29678	Front Mounting Plate	1
5	620011202	Top Spacer Bracket, Gray	1
	620011201	Top Spacer Bracket, Black	1
6	50904	RTV, 3-oz. Tube	1
7	71006	Screw, #8-32 X 2-1/4 in.	2
8	71010	Captivating Washer, #8	2
9	620013302	Drip Tray Cover, Gray	1
	620013301	Drip Tray Cover, Black	1
10	620500201	Gasket, 3/8 in. X 1/2 in. X 120 inches Long	1
11	70171	Screw #8-32 X 3/8 in.	2
12	620919520	Installation Instructions	1

### WARNING:

Disconnect power to the unit before servicing. Follow all lock out/tag out procedures established by the user. Verify all power is off to the unit before performing any work.

**Failure to comply could result in serious injury, death or damage to the equipment.**

1. Remove the hopper cover, merchandiser, and lower panel from both dispensers.
2. Apply the self-adhesive gasket to the side of one of the dispensers as shown in Figure 1. The ends of the gasket should fit tightly together.
3. Place the two dispensers into position on the counter (see Figure 2). The dispensers must be at the same height and level for the dual merchandiser to fit properly across the two dispensers. The outside to outside dimensions of the dispensers should be 44-3/8 inches (3/8-inch between the dispensers at center).
4. Remove one screw at the lower rear corner from each dispenser and install the rear mounting plate (item 3) to maintain the proper spacing between the dispensers (see Figure 2).
5. Install the “I” shaped front plate (item 4) using the four beverage panel mounting screws at the center of the dispensers.
6. Remove the top two sheetmetal screws on each cabinet wrapper at the center of the dispensers. Install the top spacer bracket (item 5) using these two screws as shown in Figure 2.
7. Install the drip tray cover (item 9) using the #8-32 screws provided to each cabinet wrapper at the center (see Figure 2). The drip trays must be at the same height for the cover to fit properly.
8. Apply RTV at the gasket - cabinet joint to seal any gaps between the dispensers.
9. Assemble the lower panel (item 2) to the dispensers with the #8-32 X 2-1/4 inch screws (item 7) and #8 captivating washers (item 8) provided in the kit.
10. Install the dual merchandiser on the two dispensers. Insert the “hooks” (three on each side) of the left and right merchandiser mounting brackets into the corresponding slots in the cabinet flanges. Push down on the left and right side of the merchandiser to fully engage the “hooks” into the cabinet slots.
11. Replace the hopper covers on the dispensers.

12. Connect electrical power to both dispensers. Both dispensers light bulbs should be illuminated. Check for proper operation of both dispensers.

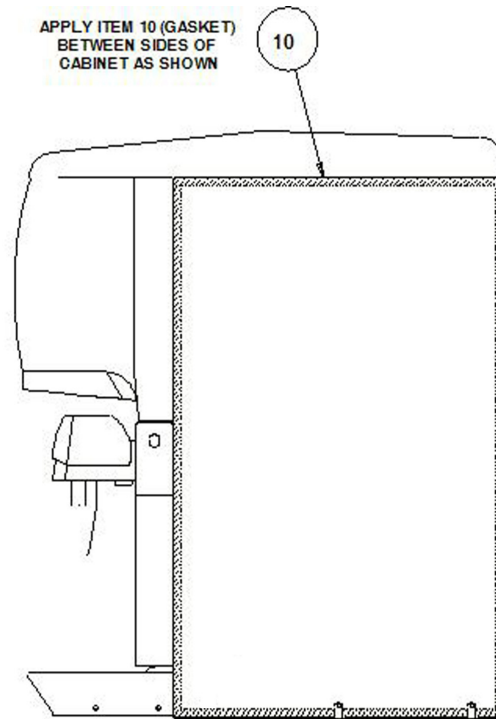

Figure 1. Gasket Installation

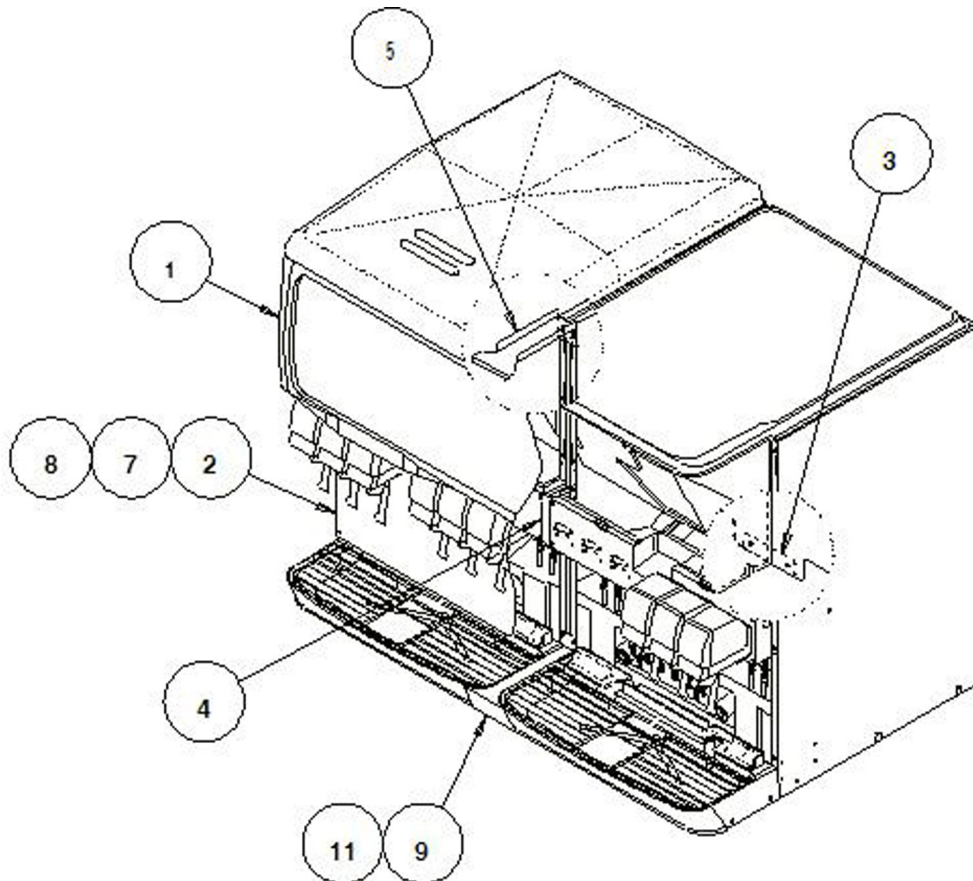

Figure 2. Parts Identification