

INSTALLATION INSTRUCTIONS

ED/DF2XX LID KIT, P/N 620201111TE AND 620201017TE

Table 1. Loose Shipped Parts

Item No.	Part No.	Name	Qty.
1	620200134	Lid and Lanyard Assembly, Black (620201111TE)	1
	620200136	Lid and Lanyard Assembly, Grey (620201017TE)	
2	15537	Cover Assembly	1
3	29565	Bracket	2
4	70217	#8 Screw	6
5	50904	RTV	1
6	91957	Label, Disconnect Power Before Cleaning	1
7	620201017TEINS	Installation Instructions	1
8	620701902	Acorn Nut, 8-32 Nylon	2
9	620701901	Sealing Washer	2
10	620037003	Baffle, Ice DF/ED 2XX	1
11	620701903	#8 Nylon Washer	2
12	620505802	Insulation Strip	1
13	630000408	Bin Thermostat Kit	1
14	70100	Hex Nut 08-32	2
15	43164	Screw 08-32	2
16	620059361	Warning Label Baffle Installation	1
17	620042927INS	Instruction Manual - Ice Bin Baffle Sheet	1

 **WARNING:**

Disconnect power to the unit before installing the adaptor following all lockout/tag out procedures established by the user. Verify that all the power is off to the unit before performing any work.

Failure to comply could result in serious injury, death or damage to the equipment.

 **WARNING:**

All ice baffle plates and bin stats, if included or recommended in this kit, must be installed as directed in this manual or the equipment manufacturer's instructions.

Failure to comply could result in serious injury, death or damage to the equipment.

 **WARNING:**

All of the attachment screws and plates must be installed as directed in this manual.

Failure to comply could result in serious injury, death or damage to the equipment.

1. Unpack and inspect the kit
2. Place insulation strip (item 12) over studs on the baffle and insert baffle assembly into the adapter lid.
3. Place (2) sealing washers (item 9) over studs and (2) flat washers (item 11), then fasten in place with (2) plastic acorn nuts (item 8).
4. Set ice maker lid on the top of the dispenser.
5. Using the slotted holes in the lid as a template, drill four (4) 0.140" diameter (9/64") holes at the bottom of the slots (see Detail A). **Use extreme care not to drill into the hopper.** Fasten the lid to the dispenser with four (4) #8 sheet metal screws, two on each side.

6. Seal the ice maker to the top of the dispenser as follows:
 - A. Apply beads of RTV around the opening in the lid and inside the perimeter of the ice maker outline so that the ice maker sets on the RTV.
 - B. Set the ice maker onto the lid and position it as shown in Fig 1.
 - C. Wipe away any excess RTV.
7. Drill $9/64$ " diameter holes into the ice maker cabinet using the bracket as a template. **Use extreme care not to drill into any ice maker components (condenser, tubing, etc.).** Secure the brackets using the screws provided.
8. Follow the ice maker manufacturer's instruction to complete the installation of the ice maker including the bin thermostat if so equipped or required. For Cornelius Ice Makers, P/N 630000408 Bin Thermostat Kit is required. Follow Installation Instructions provided with this Kit to install the thermostat.

NOTE: Bin thermostat must not interfere with the agitator rotation.

9. If the plastic acorn nuts interfere with the positioning of the plastic manual fill cover, it may be necessary to make small notches in the back of the cover to clear the acorn nuts.

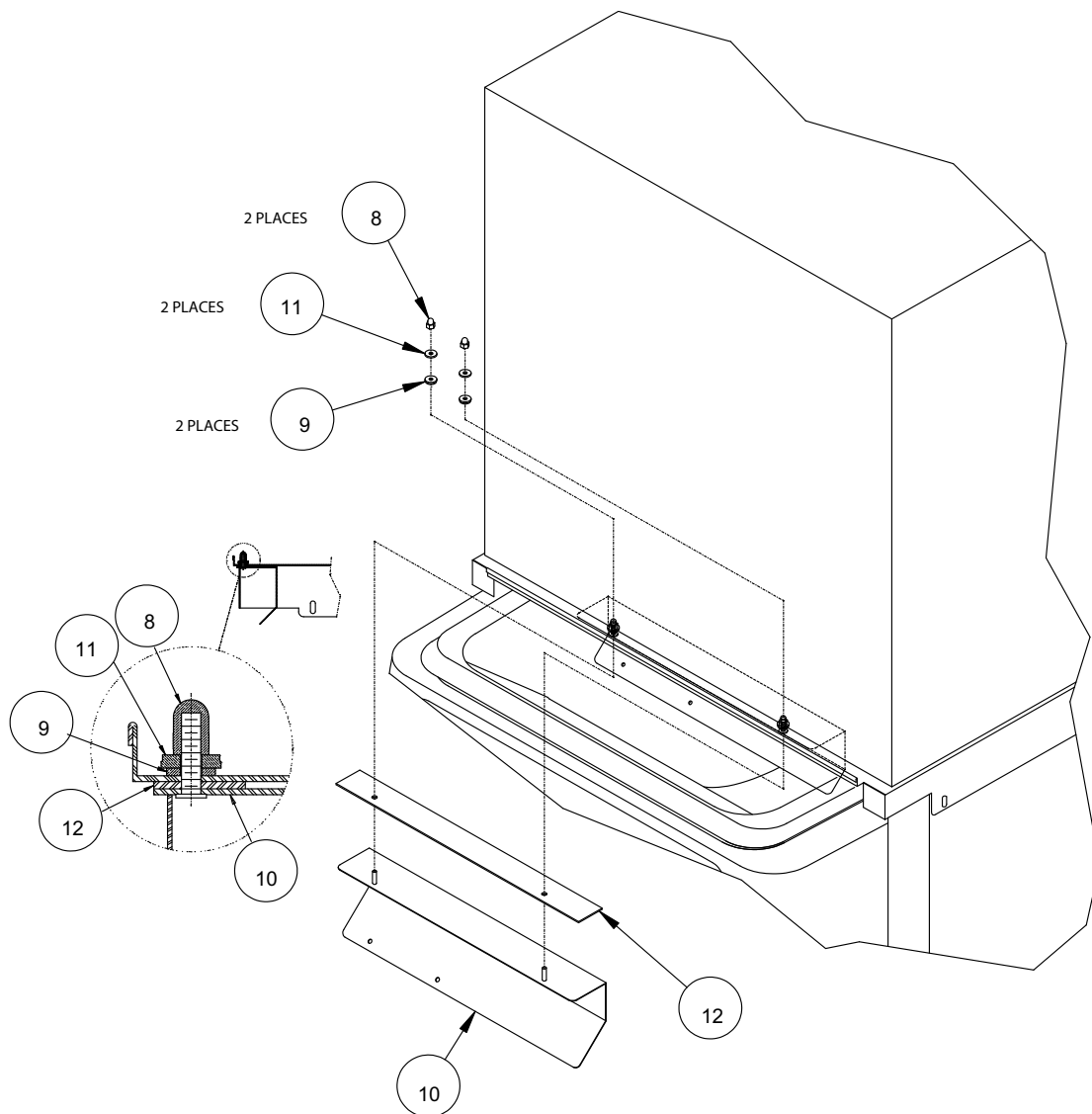

Figure 1. Parts

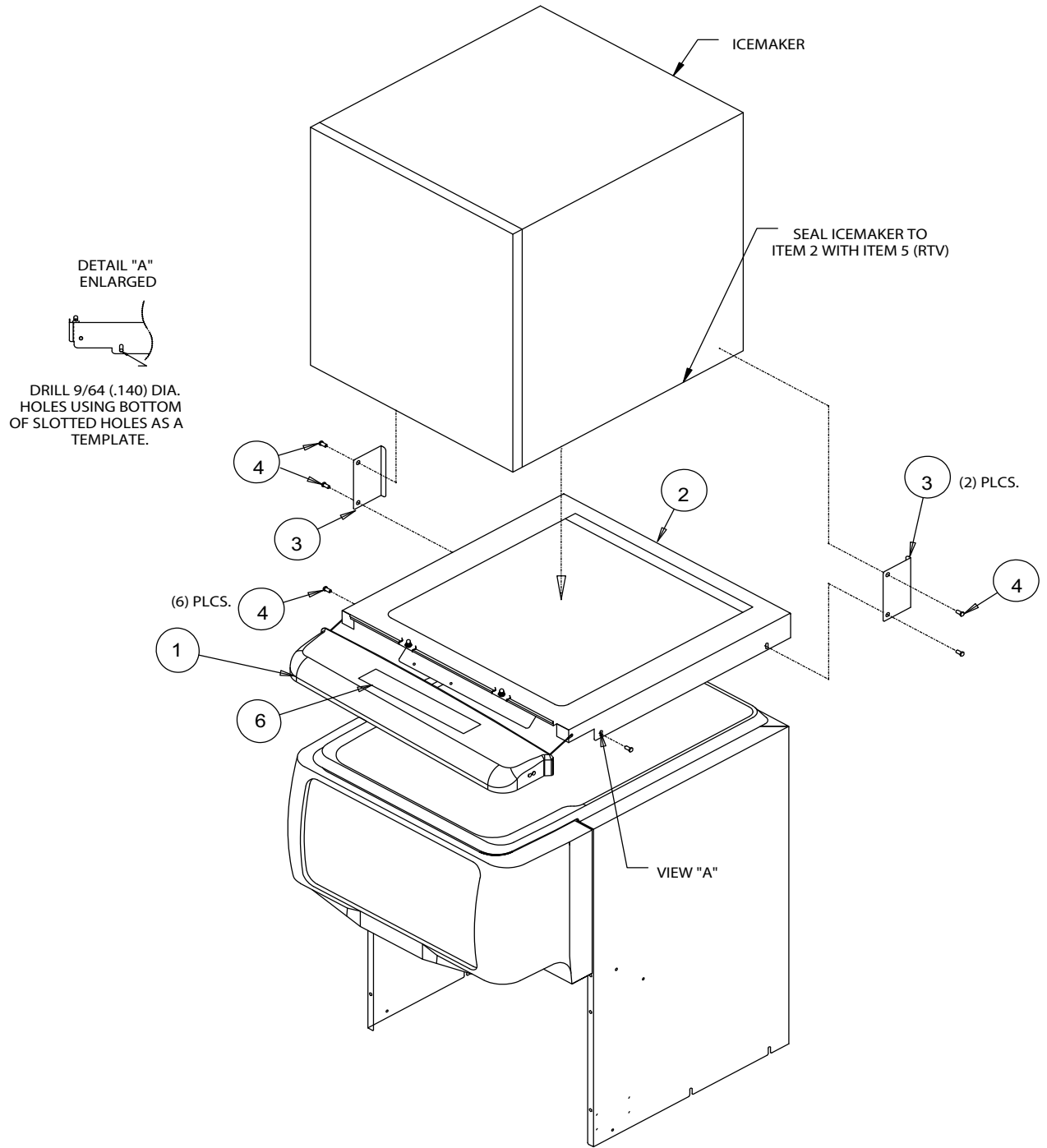

Figure 2. Dispenser Assembly

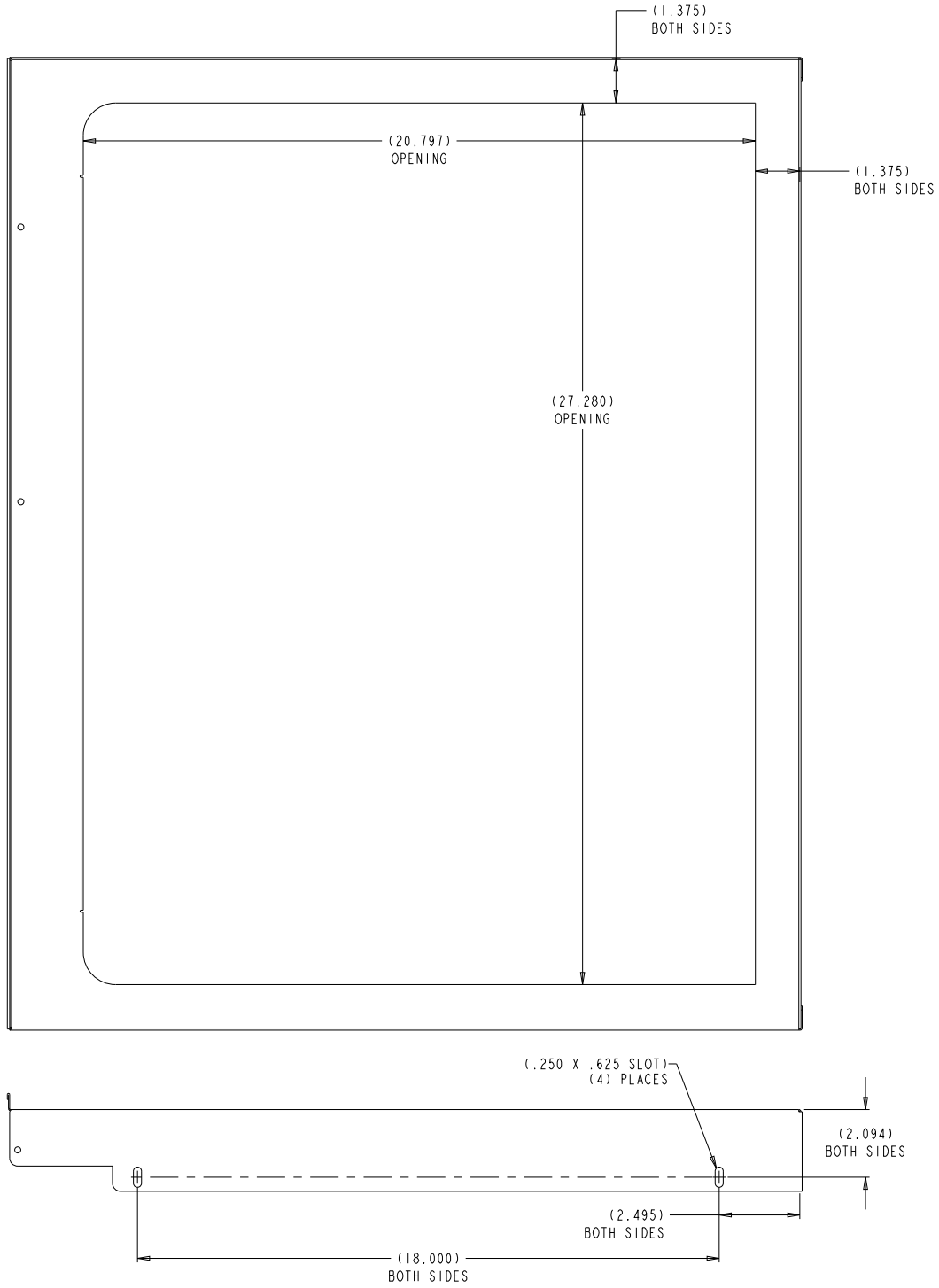

Figure 3. Reference Sheetmetal Cover Opening Dimensions for Mounting Icemaker.