

INSTALLATION INSTRUCTIONS

FOR ED/DF 2XX KIT PN 620201013TE, 620201107TE AND
629084005TE

SAFETY INSTRUCTIONS

WARNING:

Before starting installation, read and understand all safety label and warnings on the machine. Also review and understand all safety instructions in the owners, installation and service manuals.

Failure to comply could result in serious injury, death or damage to the equipment.

QUALIFIED SERVICE PERSONNEL

WARNING:

Only trained and certified electrical, plumbing and refrigeration technicians should service this unit.

All wiring and plumbing must conform to national and local codes. Failure to comply could result in serious injury, death or equipment damage.

SAFETY PRECAUTIONS

This unit has been specifically designed to provide protection against personal injury. To ensure continued protection observe the following:

WARNING:

Disconnect power to the unit before servicing. Follow all lock out/tag out procedures established by the user. Verify all power is off to the unit before performing any work.

Failure to comply could result in serious injury, death or damage to the equipment.

CAUTION:

Always be sure to keep area around the unit clean and free of clutter.

Failure to keep this area clean may result in injury or equipment damage.

Item No.	Part No.	Name	Qty.
1	620200166	Lid and Lanyard Assembly, Grey (620201013TE and 629084005TE)	1
	620200164	Lid and Lanyard Assembly, Black (620201107TE)	
2	15506	Lid Assembly	1
3	29565	Bracket	2
4	70217	#8 Screw	6
5	50904	RTV	1
6	90221	Label	1
7	620201013TEINS	Installation Instruction	1
8	620701902	Acorn Nut, 8-32 Nylon	2
9	620701901	Sealing Washer	2
10	620042928	Baffle, Ice DF/ED150	1
11	620701903	#8 Nylon Washer	2
12	620505804	Insulation Strip	1
13	43164	Screw #08-32	2
14	70100	Hex Nut #08-32	2
15	620059361	Warning Label Baffle Installation	1
16	620042928INS	Instruction Manual - Ice Bin Baffle Sheet	1

INSTALLATION INSTRUCTIONS

1. Unpack kit.
2. Place insulation strip (item 11) over studs on the baffle and insert baffle assembly into the adapter lid.
3. Place (2) sealing washers (item 8) over studs and (2) flat washers (item 10), then fasten in place with (2) plastic acorn nuts (item 7).
4. Set ice maker lid on the top of the dispenser.
5. Using the slotted holes in the lid as a template, drill four (4) .1401 diameter (9/64) holes at the bottom of the slots (see detail A). Use extreme care not to drill into the hopper. Fasten the lid to the dispenser with four (4) #8 sheet metal screws, two on each side.
6. Seal the ice maker to the top of the dispenser as follows:
 - A. Run beads of RTV around the opening in the lid and inside of the perimeter of the ice maker outline so that the ice maker will set on the RTV.
 - B. Set the ice maker onto the lid and position it as required.
 - C. Wipe away the excess RTV.
7. Drill 9/64" diameter holes into the ice maker cabinet using the bracket as a template. Use extreme care not to drill into any ice maker components (condenser, tubing, etc.). Secure the brackets using the screws provided.
8. Follow the ice maker manual's manufacturers instruction to complete the installation of the ice maker.

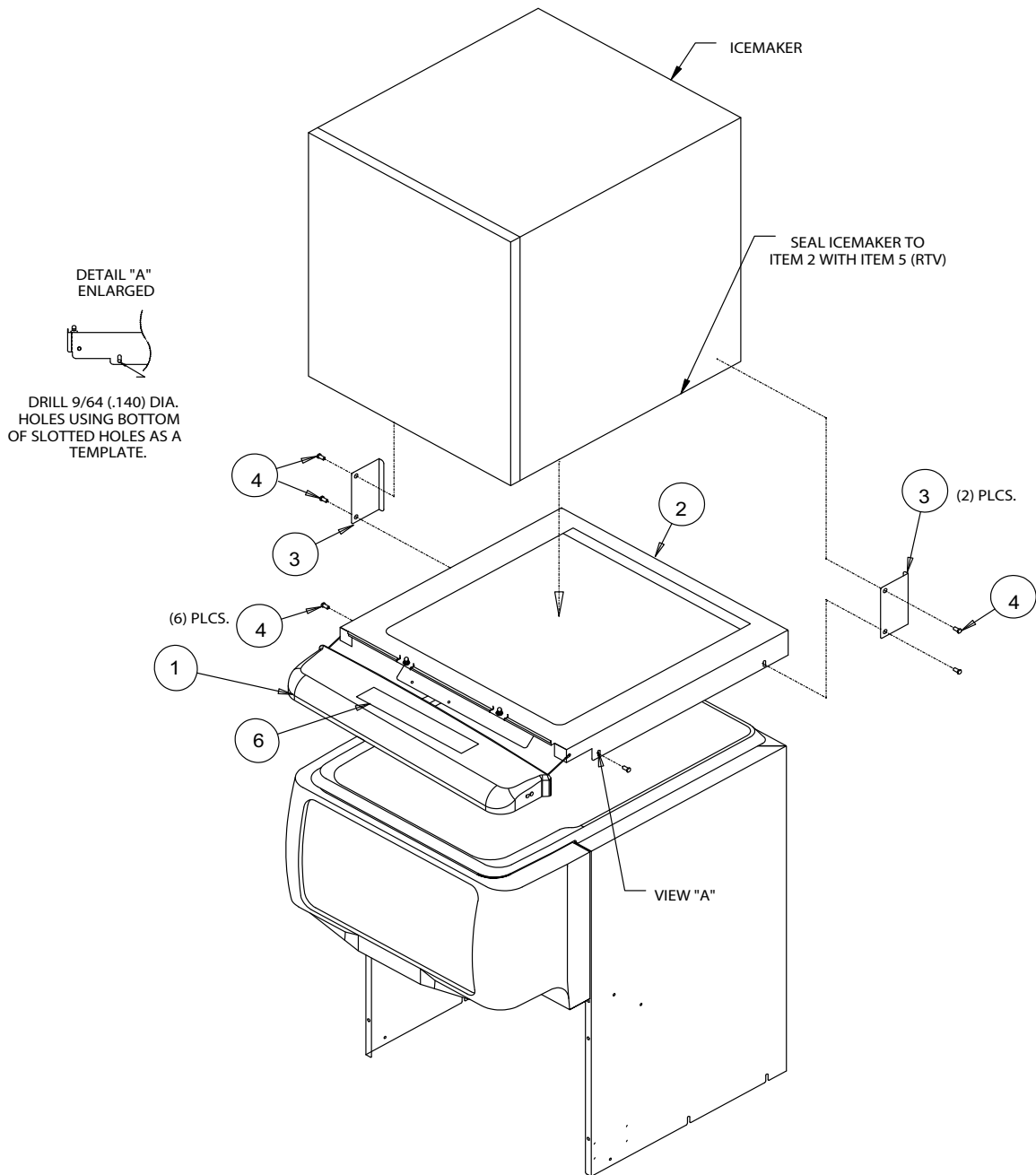

Figure 1.

Figure 1. Baffle Installation

9. If the plastic acorn nuts interfere with the positioning of the plastic manual fill cover, it may be necessary to make small notches in the back flange of the cover to clear the acorn nuts.

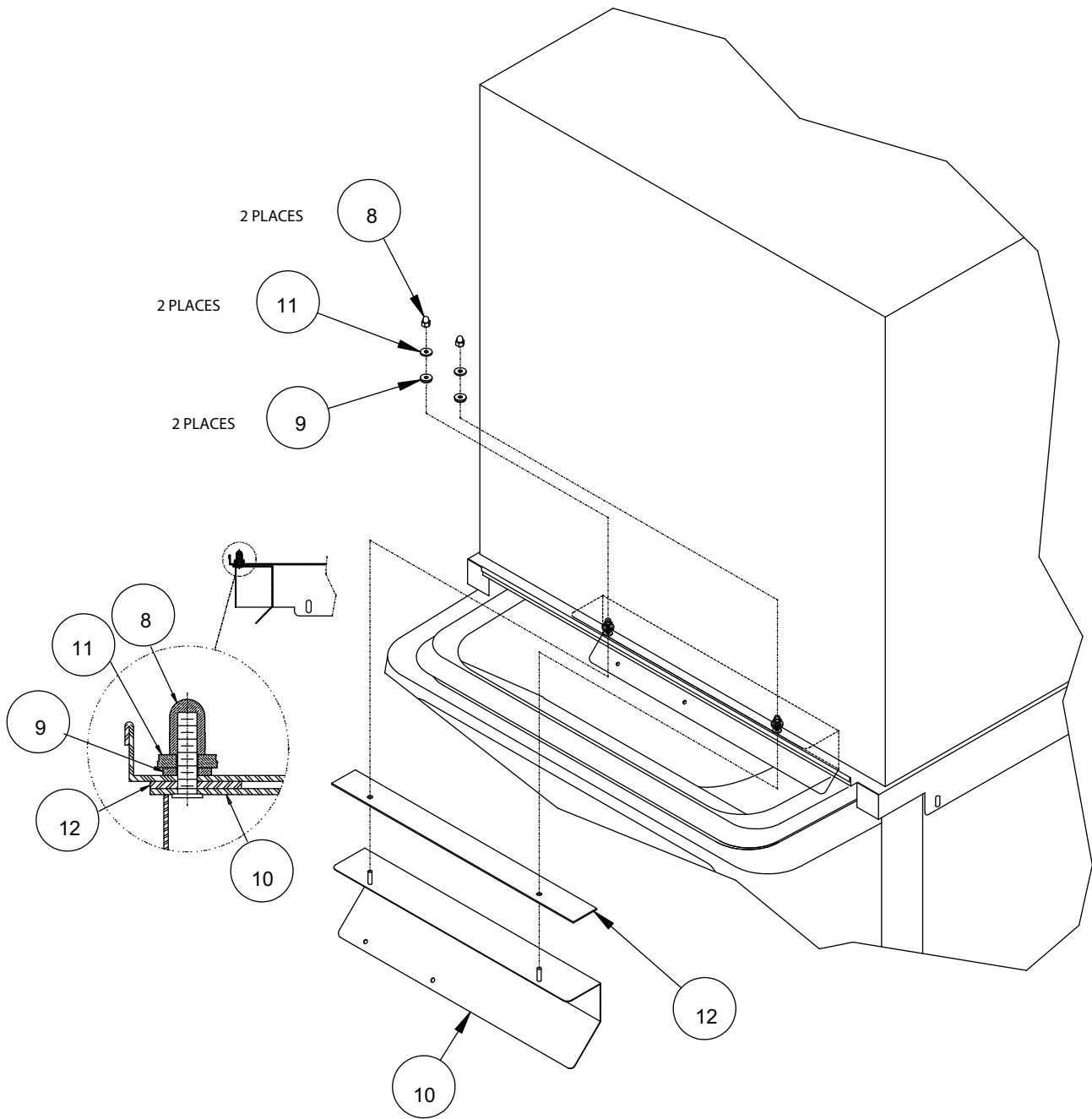

Figure 2.

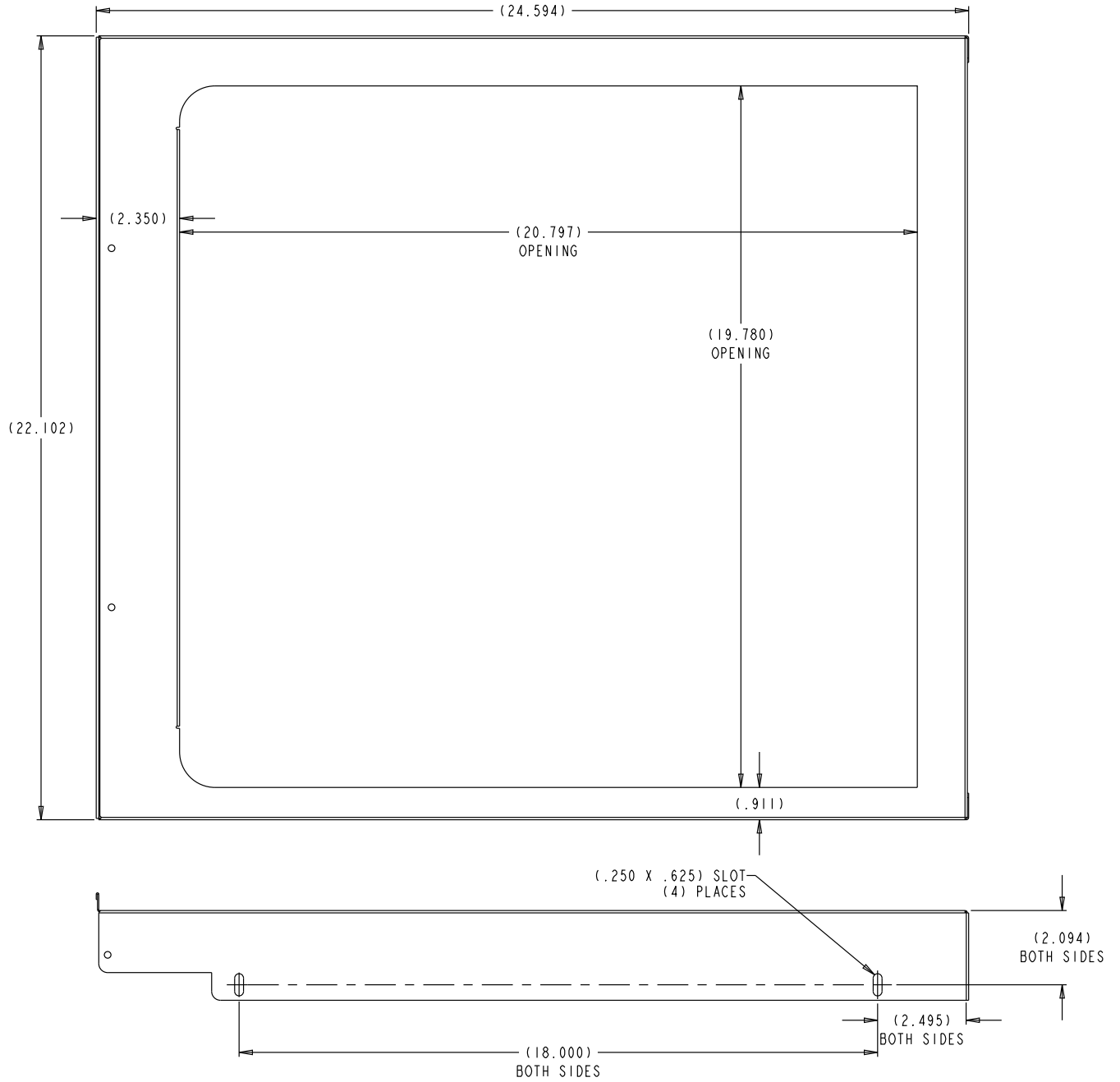

Figure 3. Reference Sheetmetal Cover Opening Dimensions for Mounting Ice Maker