

INSTALLATION INSTRUCTIONS

ED1XX ICE MAKER ADAPTER LID KITS (P/N 629087985TE, 629087984TE)

SAFETY

 **WARNING:**

Before starting installation, read and understand all safety label and warnings on the machine. Also review and understand all safety instructions in the owners, installation and service manuals.

Failure to comply could result in serious injury, death or damage to the equipment.

QUALIFIED SERVICE PERSONNEL

 **WARNING:**

Only trained and certified electrical, plumbing and refrigeration technicians should service this unit.

All wiring and plumbing must conform to national and local codes. Failure to comply could result in serious injury, death or equipment damage.

SAFETY PRECAUTION

This unit has been specifically designed to provide protection against personal injury. To ensure continued protection observe the following:

 **WARNING:**

Disconnect power to the unit before servicing. Follow all lock out/tag out procedures established by the user. Verify all power is off to the unit before performing any work.

Failure to comply could result in serious injury, death or damage to the equipment.

SAFETY PRECAUTIONS

This unit has been specifically designed to provide protection against personal injury. To ensure continued protection observe the following:

 **CAUTION:**

Always be sure to keep area around the unit clean and free of clutter.

Failure to keep this area clean may result in injury or equipment damage.

Table 1. Loose Shipped Parts

Item No.	Part Number	Part Name	Qty.
1.	620046011	Lid Assembly	1
2.	620200160	Lid and Lanyard Assembly - Black (629087985TE)	1
	620200162	Lid and Lanyard Assembly - Grey (629087984TE)	
3.	620042928	Baffle Ice ED150 Adapter Lid	1
4.	02394	Kit Ice Diverter	1
5.	22127	Bracket	2
6.	70217	Screw, Mounting	6
7.	91957	Label	1
8.	629087985TEINS	Installation Instruction	1
9.	620701902	Acorn Nut, Nylon	2
10.	620701901	Sealing Washer	2
11.	621701903	Nylon Washer	2
12.	50904	RTV	1
13.	43164	Screw 08-32	2
14.	70100	Hex Nut 08-32	2

 **WARNING:**

All ice baffle plates and bin stats, if included or recommended in this kit, must be installed as directed in this manual or the equipment manufacturer's instructions.

Failure to comply could result in serious injury, death or damage to the equipment.

 **WARNING:**

All of the attachment screws and plates must be installed as directed in this manual.

Failure to comply could result in serious injury, death or damage to the equipment.

1. Unpack and inspect the kit. Refer to Figure 1. and for component details.
2. Insert the ice baffle (item 3) into the lid assembly (item1, Figure 1.)

IMPORTANT: The baffle prevents ice from overflowing the manual fill area during agitation/ dispensing with a full storage bin and forcing the manual fill cover off.

3. Place the sealing washers (item 10) over the studs and flat washers (item 11) then fasten in place with the nylon acorn nuts (item 9).
4. Set the lid assembly onto the dispenser. Using the slotted holes on the side of the lid as a template, drill four (4) 9/ 64" diameter holes at the bottom of the slots ()

 **CAUTION:**

Use extreme care not to drill into the hopper. Use a drill stop to ensure that the drill bit does not penetrate deeper than 1/4" past the sheet metal. Failure to do so could result in a hole in the hopper, greatly reducing the efficiency of both the dispenser and ice maker.

5. Fasten the lid to the dispenser with four (4) #8 sheet metal screws (item 6), two on each side.

6. Seal the ice maker to the top of the dispenser as follows:
 - A. Run beads of RTV (item 12) around the opening in the lid assembly and inside of the perimeter of the ice maker outline so that the ice maker will set on the RTV.
 - B. Set the ice maker onto the lid assembly and position it as required.
 - C. Wipe away the excess RTV.
7. Drill 9/64" diameter holes into the ice maker cabinet using the bracket (item 5) as a template. Use extreme care not to drill into any ice maker components (condenser, tubing, etc.). Secure the brackets using four (4) #8 sheet metal screws (item 6).
8. Follow the ice maker manufacturers instruction to complete the installation of the ice maker including the bin thermostat if so equipped or required.

CAUTION:

The bin-stat must not interfere with the agitator rotation not be in the path of the ice falling from the ice maker. If so, bend the bracket out of the way.

9. If the plastic acorn nuts interfere with the positioning of the plastic manual fill cover, it may be necessary to make small notches in the back flange of the cover to clear the acorn nuts.
10. Apply the label (item 7) on the front of the cover.

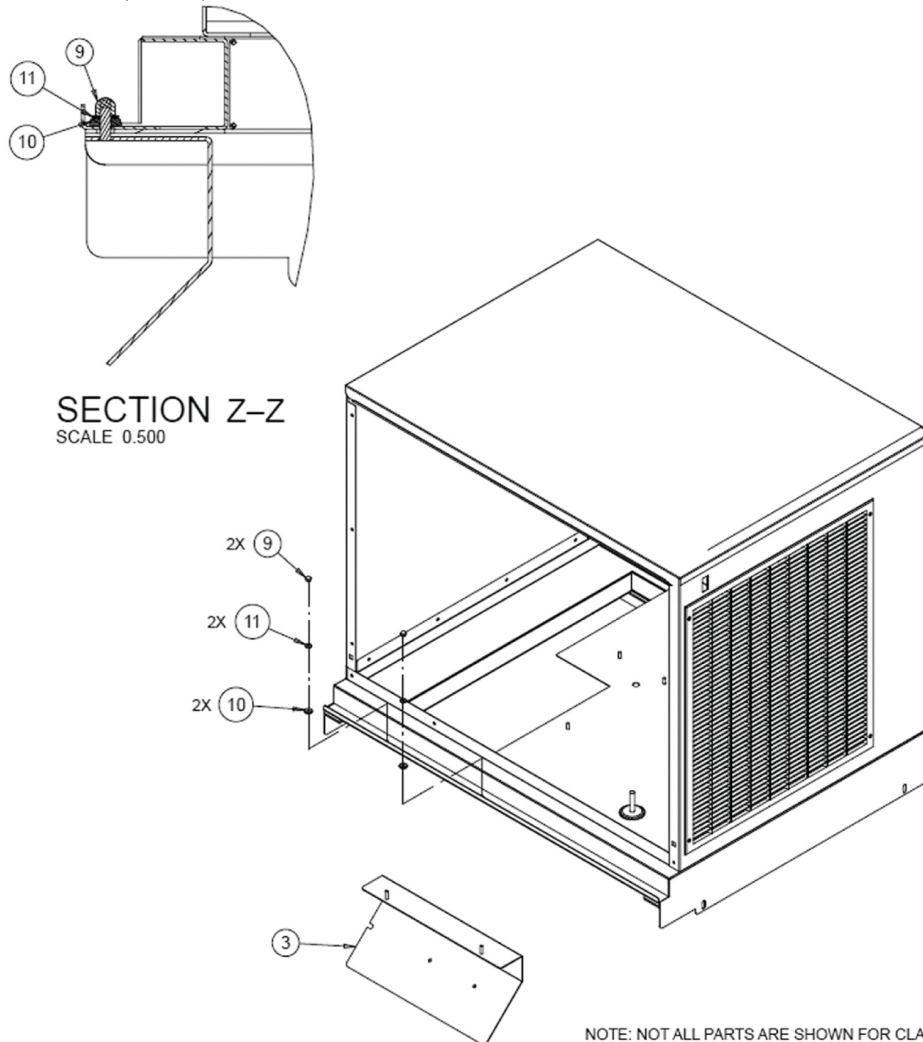
Figure 1. Parts

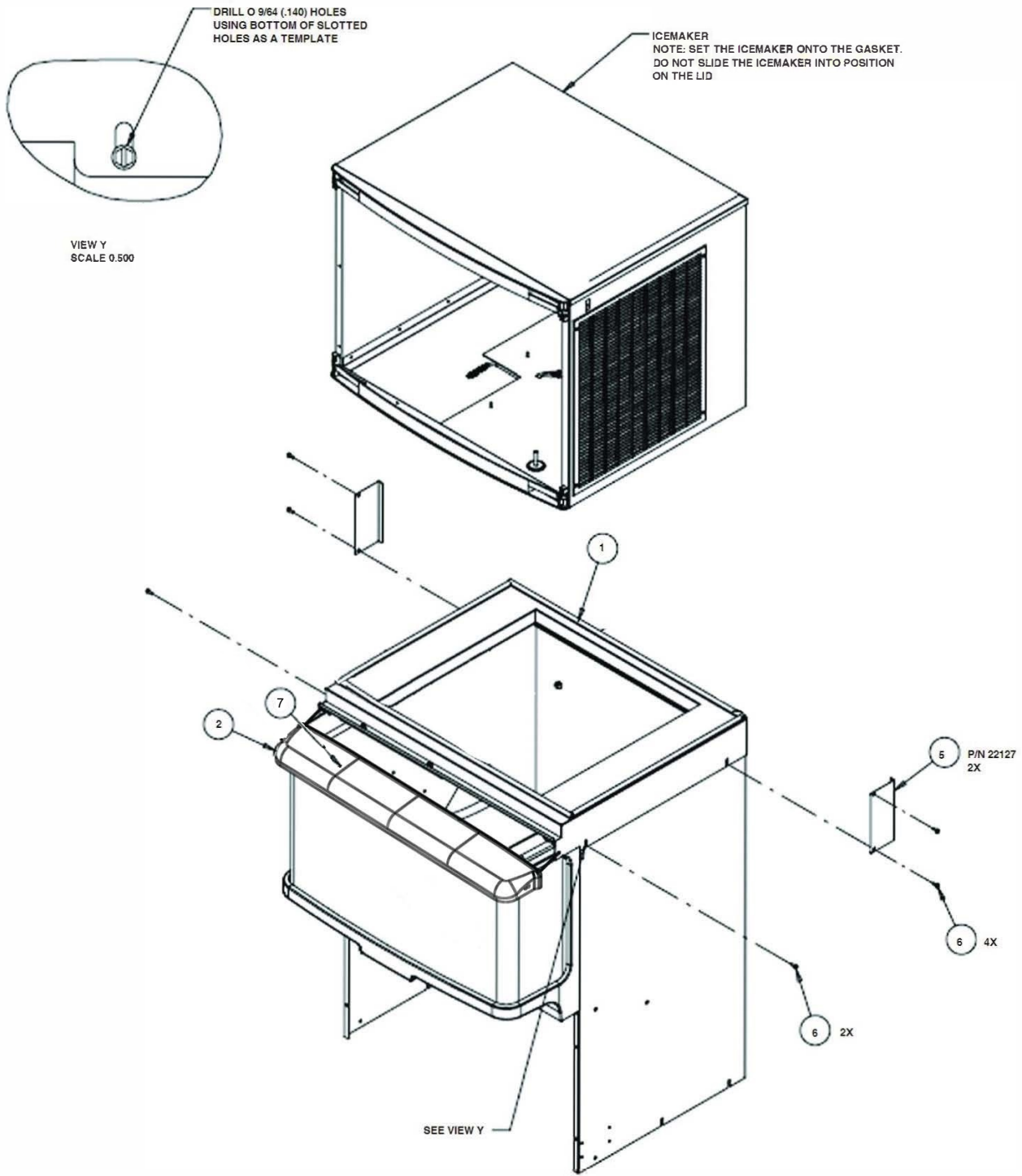

Figure 2. Dispenser Assembly

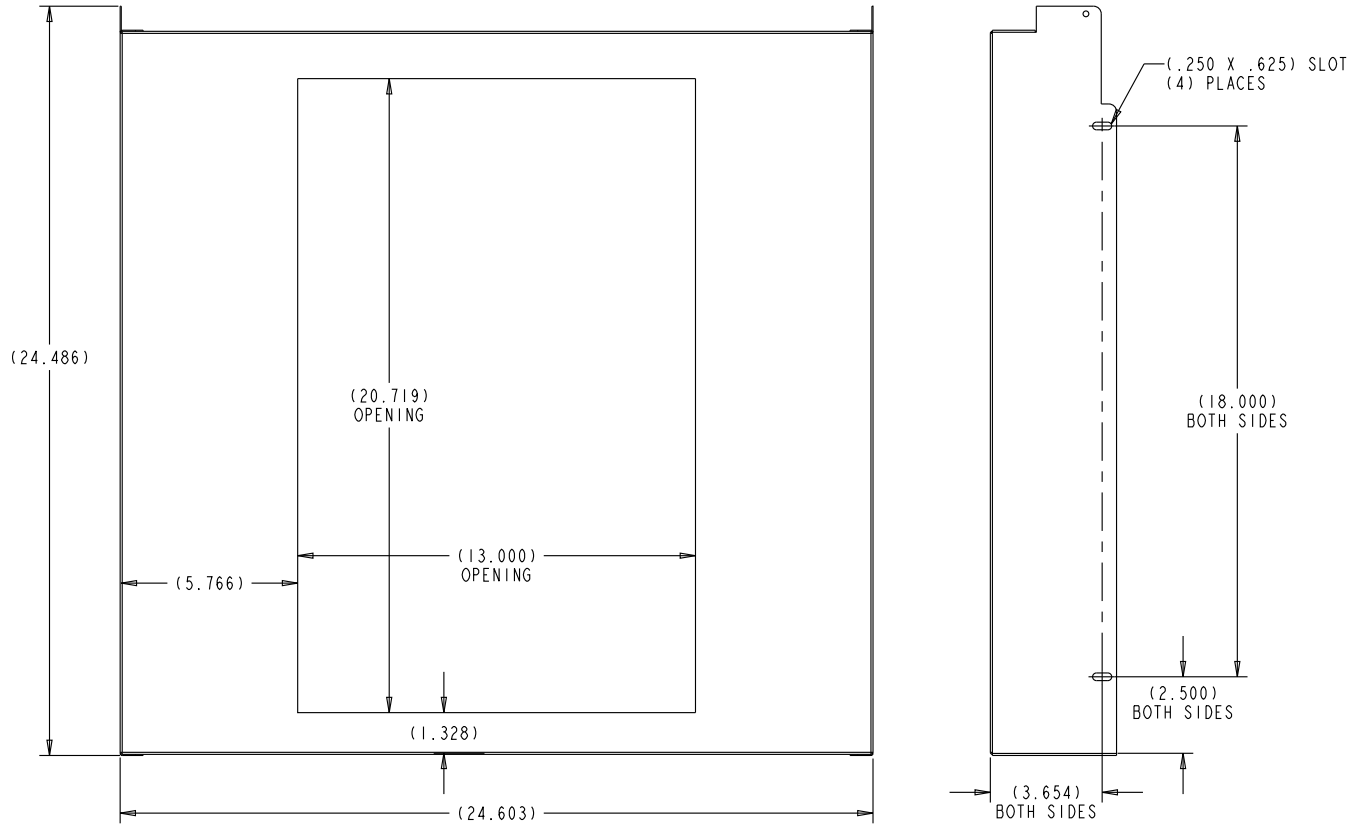

Figure 3. Reference Sheetmetal Cover Opening Dimensions for Mounting Icemaker.

