



INSTALLATION INSTRUCTIONS

Flavor Fusion 255 with Drip Tray to 'Z' Style Unit Conversion

SAFETY INSTRUCTIONS

⚠ WARNING:

Before starting installation, read and understand all safety label and warnings on the machine. Also review and understand all safety instructions in the owners, installation and service manuals.

Failure to comply could result in serious injury, death or damage to the equipment.

QUALIFIED SERVICE PERSONNEL

⚠ WARNING:

Only trained and certified electrical, plumbing and refrigeration technicians should service this unit.

All wiring and plumbing must conform to national and local codes. Failure to comply could result in serious injury, death or equipment damage.

SAFETY PRECAUTIONS

This unit has been specifically designed to provide protection against personal injury. To ensure continued protection observe the following:

⚠ WARNING:

Disconnect power to the unit before servicing. Follow all lock out/tag out procedures established by the user. Verify all power is off to the unit before performing any work.

Failure to comply could result in serious injury, death or damage to the equipment.

⚠ CAUTION:

Always be sure to keep area around the unit clean and free of clutter.

Failure to keep this area clean may result in injury or equipment damage.

INSTRUCTIONS

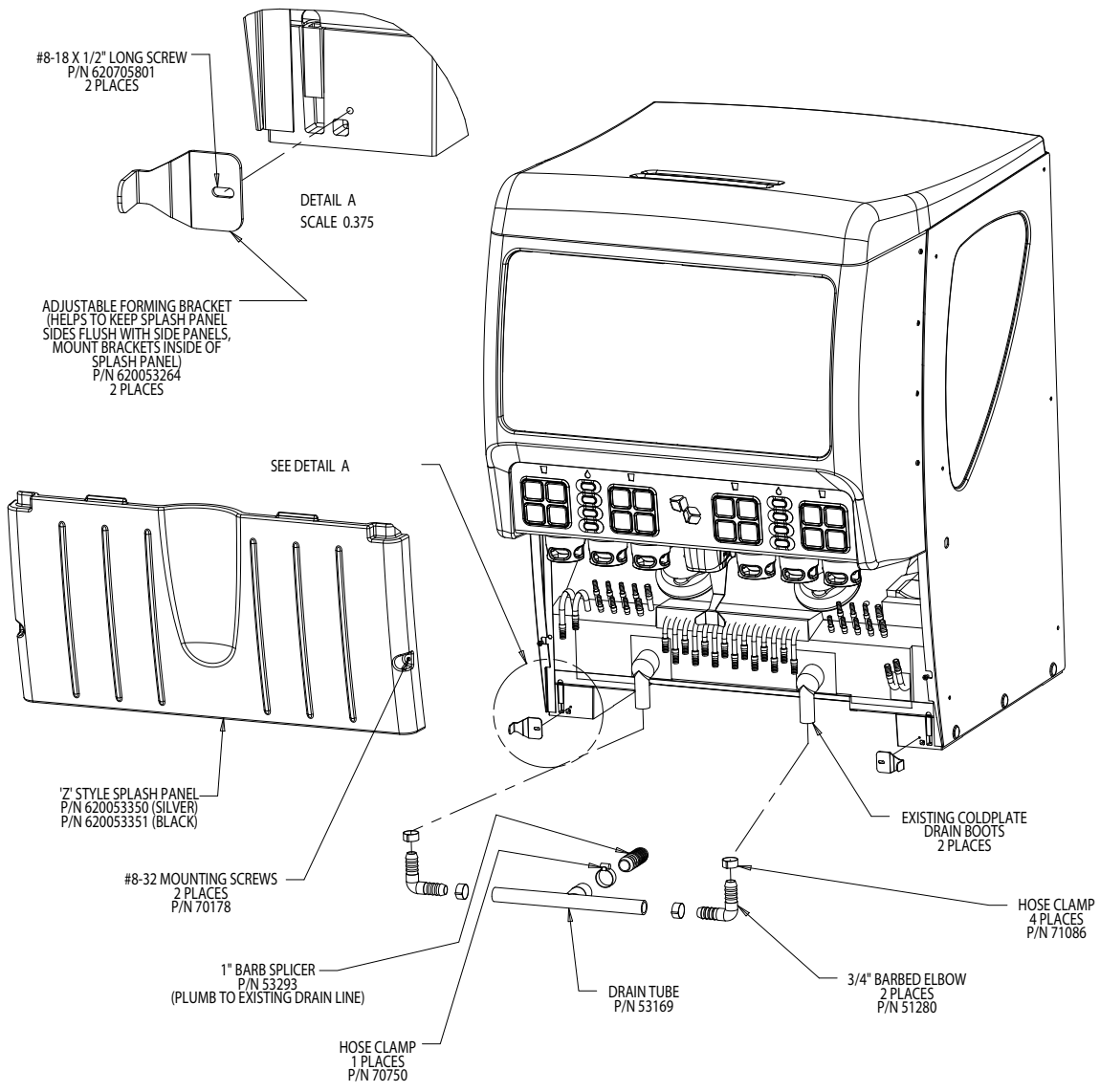

Figure 1.

! IMPORTANT:

Be sure to insulate all fittings/hose with insulation tube and tape supplied in kit. Failure to do so will lead to condensation problem. This equipment must be installed with adequate bracket flow protection to comply with applicable federal, state and local codes.