

# INSTALLATION INSTRUCTIONS

## FLAVORFUSION ICEMAKER ADAPTOR KIT FOR P/N 629087980

### SAFETY INSTRUCTIONS

 **WARNING:**

Before starting installation, read and understand all safety label and warnings on the machine. Also review and understand all safety instructions in the owners, installation and service manuals.

**Failure to comply could result in serious injury, death or damage to the equipment.**

### QUALIFIED SERVICE PERSONNEL

 **WARNING:**

Only trained and certified electrical, plumbing and refrigeration technicians should service this unit.

**All wiring and plumbing must conform to national and local codes. Failure to comply could result in serious injury, death or equipment damage.**

### SAFETY PRECAUTIONS

This unit has been specifically designed to provide protection against personal injury. To ensure continued protection observe the following:

 **WARNING:**

Disconnect power to the unit before servicing. Follow all lock out/tag out procedures established by the user. Verify all power is off to the unit before performing any work.

**Failure to comply could result in serious injury, death or damage to the equipment.**

 **CAUTION:**

Always be sure to keep area around the unit clean and free of clutter.

**Failure to keep this area clean may result in injury or equipment damage.**

## PROCEDURES

### WARNING:

All of the attachment screws and plates must be installed as directed in this manual. Failure to comply could result in serious Injury, Death or Damage to the equipment.

1. Remove and discard the plastic hopper lid from the top of the dispenser.
2. Remove all ice from the inside of the hopper.
3. Place ice slide into ice drop opening in the bin (see Figure 1). Be sure the ice slide is securely installed.

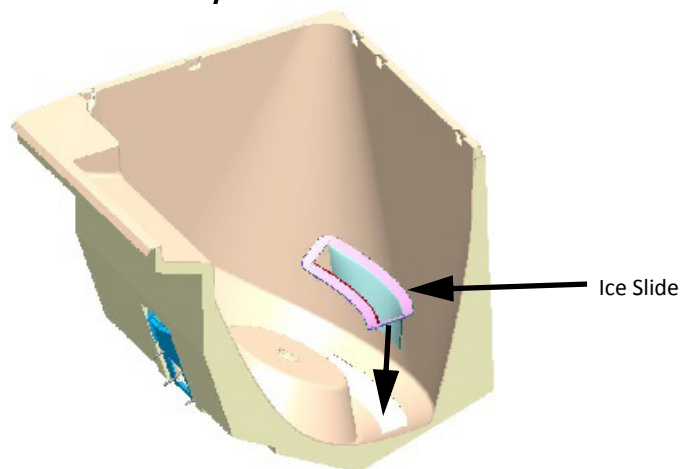

**Figure 1. Ice Slide Assembly**

4. Place bar into first set of pockets inside the hopper.
5. Place ice maker rail supports into the pockets in the ice bin as shown in Figure 2.

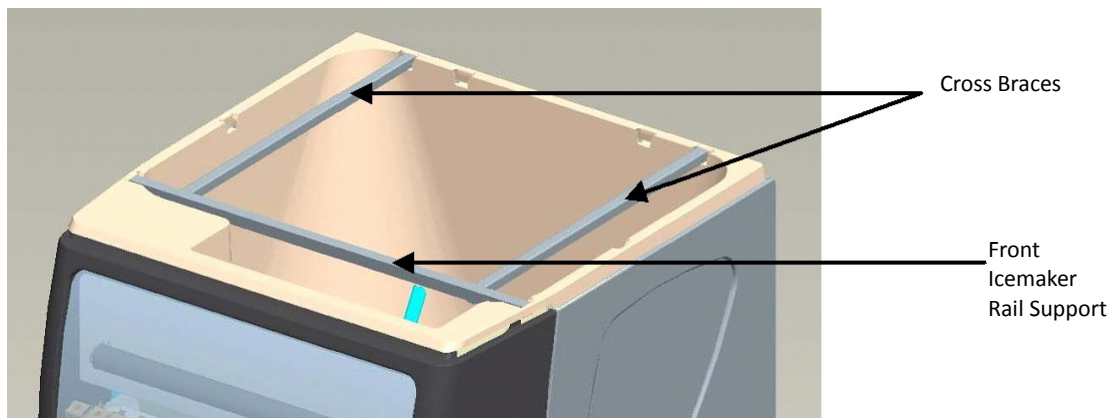

**Figure 2.**

6. Hook cross braces over top of bar and place into inner pockets inside the hopper (see Figure 3).
7. Place Icemaker Adaptor Kit on top of dispenser.

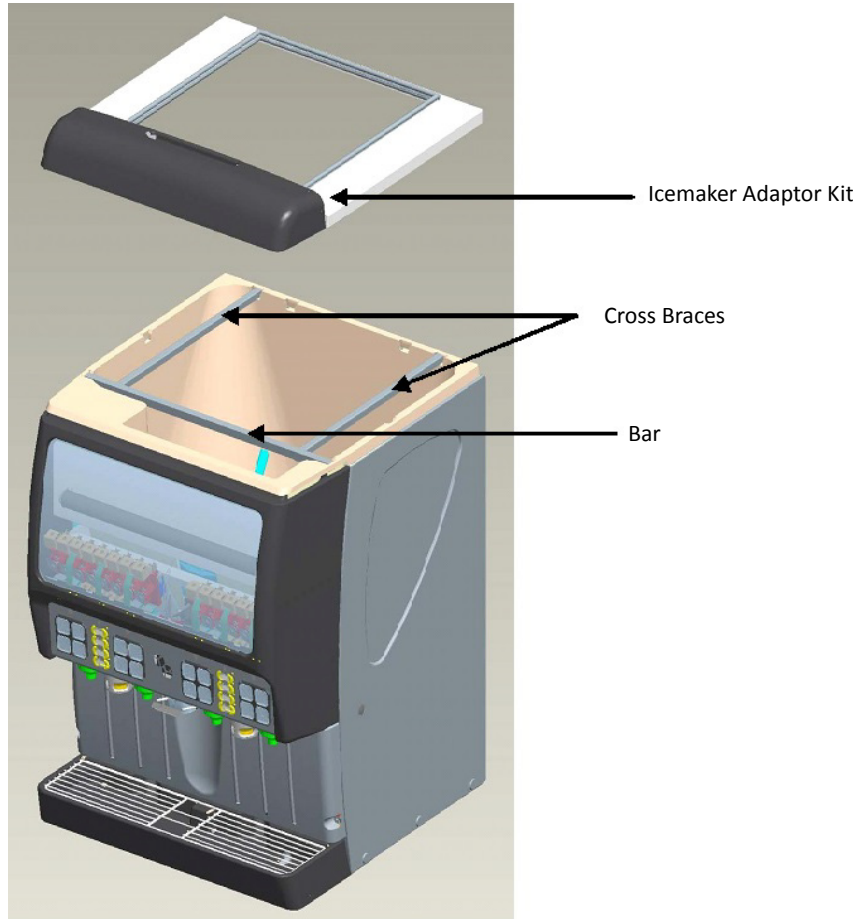

**Figure 3.**

8. Place icemaker on top of the adapter lid (see Figure 4). Dimensions in (Figure 4) are to aid in installation only. Be sure that the icemaker ice drop tubes are clearly within the adapter lid opening. Failure to do so may cause damage to icemaker.
9. Apply continuous bead of NSF international (NSF) listed silastic sealant (Dow 732 or equivalent), to seal the icemaker to the top of the adapter lid. All excess sealant must be wiped away immediately.

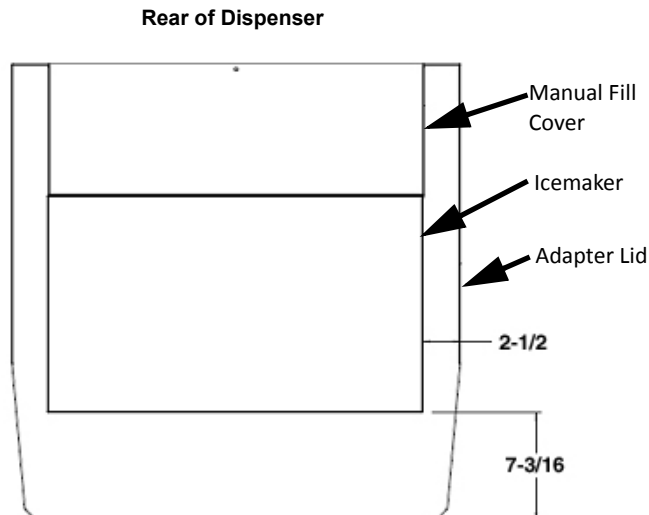

**Figure 4.**

10. Install the icemaker mounting brackets as shown in (Figure 5). Using the brackets as a template, drill 136 diameter (#29 drill size) holes into the icemaker cabinet and the adaptor lid. Use care not to drill into any icemaker components (condenser, tubing, etc.). Secure the brackets using the #10 sheetmetal screws provided.

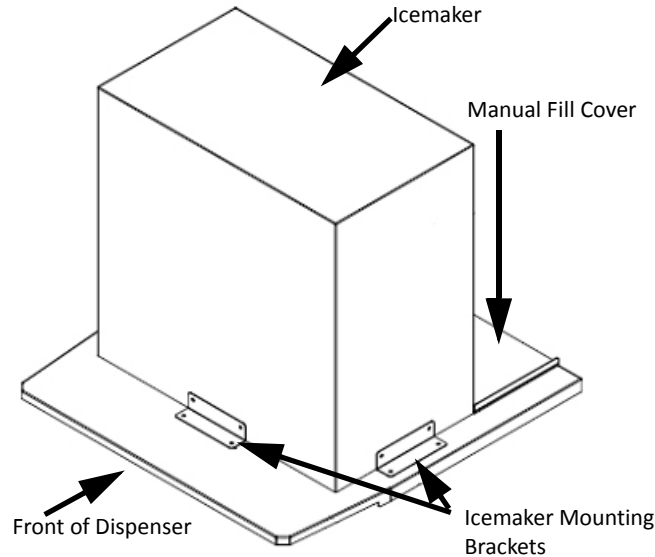

Figure 5.

11. Follow the icemaker manufacturer’s instructions to complete the installation of the icemaker including the bin thermostat.
12. Secure the manual ice fill cover in position on the lid over the rear hopper access opening with thumb screw. Note that the gasket should be compressed to form a seal against the icemaker cabinet with the cover secured in position.
13. Adjust the agitation time (agitator timer board located inside the electrical box) to 2 sec ON, 3 hours OFF (see Figure 6).

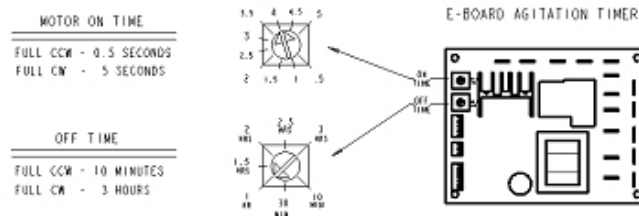

Figure 6.

14. Reconnect electrical power to the dispenser.
15. Verify the function and operation of both the icemaker and dispenser.
16. The next steps discuss loading and securing the icemaker onto the kit. Please read all the following steps to determine which mounting method should be utilized. Equally important is to determine if there is sufficient access in the area of the mounting brackets after the dispenser is lifted onto the counter. Access should be carefully considered before installation continues because sufficient room is required for drilling holes, installing screws, etc.

Two options are supplied with this kit for securing the icemaker to the kit. (See Figure 7)

**Option 1:** Includes two flat brackets. This method may be used if there is sufficient access to the back of the dispenser in the areas of the mounting brackets.

**Option 2:** Includes two angle brackets. This method may be used if there is not sufficient access to the back of the dispenser in the areas of the mounting brackets. Pre-drilling holes should be considered when using this option.

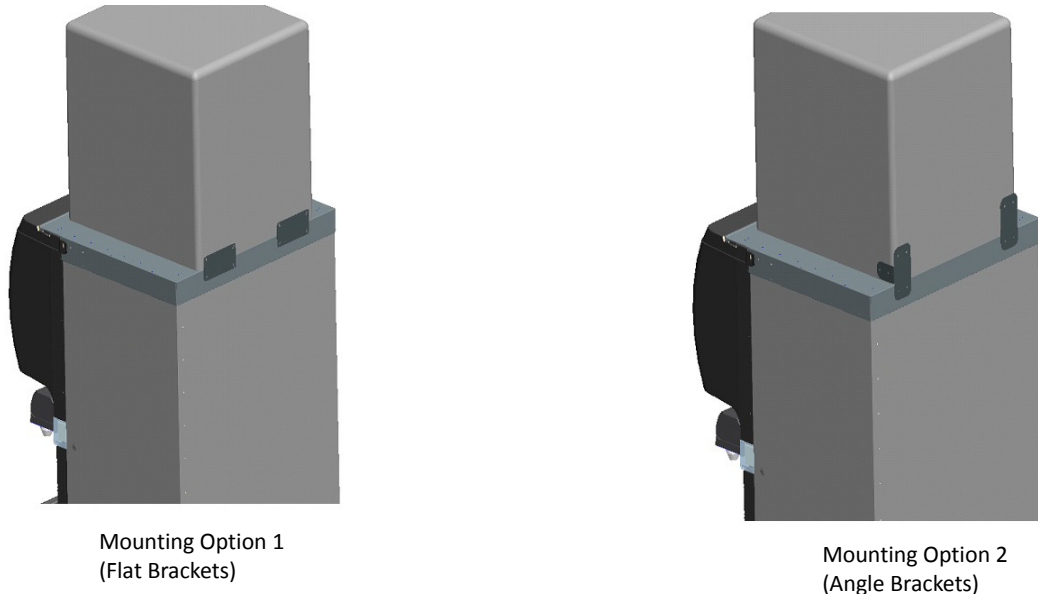

**Figure 7.**

17. The next step is to secure the icemaker to the kit. Depending on the mounting method chosen, use the appropriate brackets (supplied) as templates to drill four 9/64" (.140" Dia.) holes into the back side of the adaptor kit. Drill four holes of the same diameter into the icemaker (Figure 7). Ensure the location of the brackets will not damage the kit or the icemaker prior to drilling any holes.

**IMPORTANT: Use extreme caution not to drill into any other components.**

Drill depths should not go further than the thickness of the material being drilled (just enough to go through). Secure the two brackets using the screws provided.

Installation is complete. For optimal performance, do not fill ice bin more than 2/3 capacity (maximum fill is 4" below top of bin).