

---

---

**ILLUSTRATED PARTS LIST**

**ICE PEAK DISPENSER**

**2 BOWL 115/60 AUTOFILL DISPENSER AND AUTOFILL KIT**



**ILLUSTRATED PARTS LIST**

**ICE PEAK GRANITA DISPENSER**

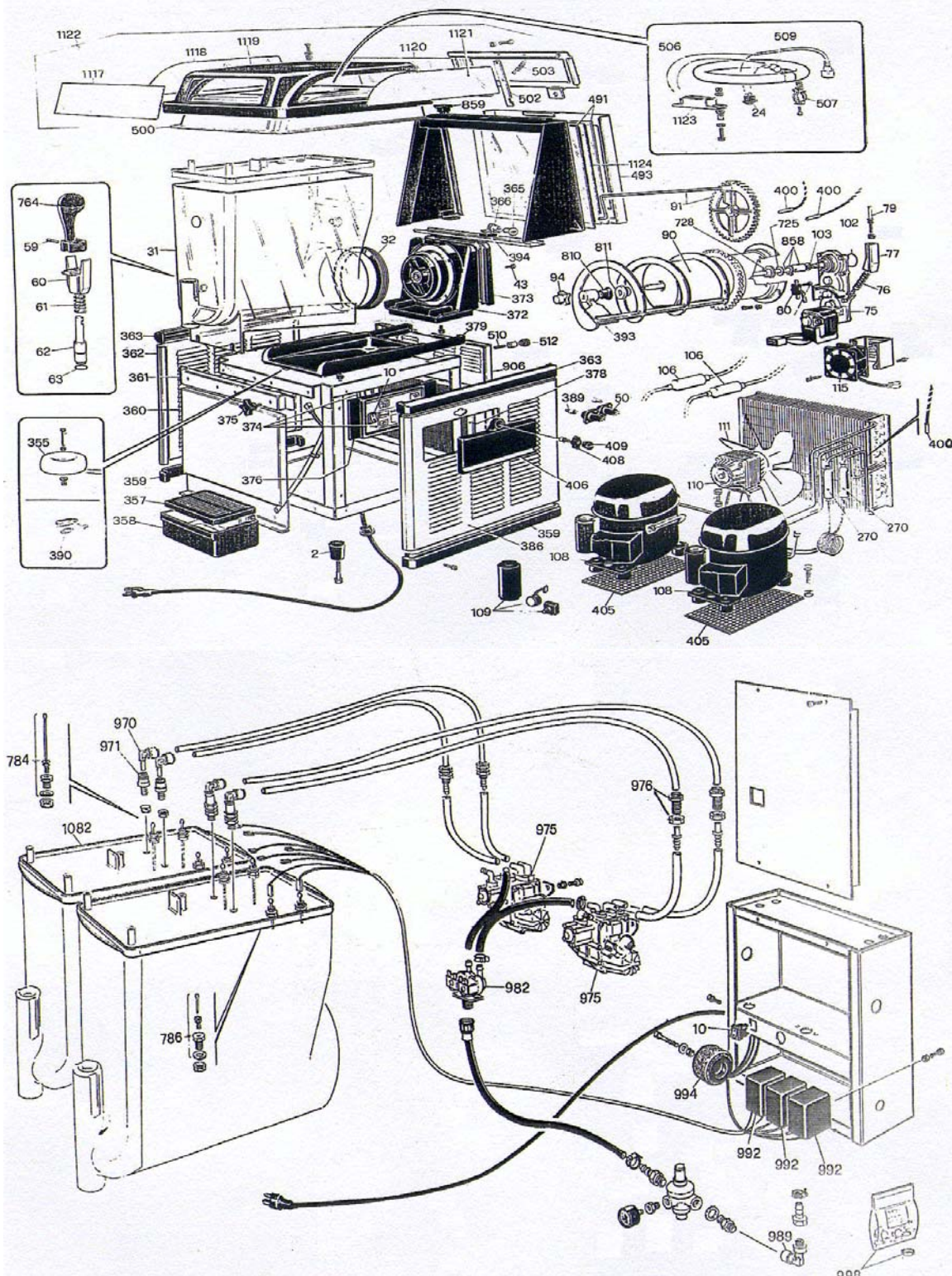



Internet: [www.bevcore.com](http://www.bevcore.com)  
 Email: [custcare@bevcore.com](mailto:custcare@bevcore.com)  
 Phone: 866-275-6392  
 Fax: 866-329-6392

## ILLUSTRATED PARTS LIST

### ICE PEAK GRANITA DISPENSER

Item No.	Part No	Description
2	1030312	Foot Supporting
10	1030376	General Power Switch
24	1030396	Lid Light Switch
31	1030313	Bowl 12 LT.
32	1030320	Seal for Bowl
50	1030478	Fuse Holder
59	1030339	Dispensing Valve Pin ID Models
60	1030314	Dispensing Valve Upper Body with Holes
61	1030390	Dispensing Valve Spring
62	1030316	ID Style Valve Lower Body Plunger
63	1030398	Dispensing Valve O-ring
75	1030378	Gearmotor 115-220/60
76	1030397	Consistency Control Spring
77	1030336	Bushing Consist, Cntrl Spring
79	1030335	Consistency Control Pin
80	1030382	Limit Microswitch
90	1030343	Evaporator
91	1030337	Upper Mixing Unit
94	1030331	Securing Bolt for Auger
102	1030399	O-ring for Gear Motor
103	1030930	Scraping Washer
106	1030342	Accumulator
108	1030401	Compressor
109	1030475	Condenser Elcetrical Kit, 115
110	1030350	Fan Motor for Condenser 82-4025/64 (115/60 Model Only)
111	1030354	Impeller (VA 254-25 Condenser Fan Blade) (115/60 and 220/60 Models Only)
115	1030370	Fan Motor for Gear Box (115/60 Model Only)
270	1030360	Filter Drier, Single Connection
355	1030394	Transformer (In 115V, Out 12) (115/60 Model Only)
357	1030330	Drip Tray Grid Black
358	1030483	Black Grid Tray
359	1030366	Black Lower Trim
360	1030363	Stainless Steel Lower Front Panel
361	1030473	Stainless Steel Upper Front Panel
362	1030361	Stainless Steel Left Side Panel
363	1030368	Black Upper Trim
365	1030959	Light Bulb
366	1030476	Lamp Holder

Item No.	Part No	Description
372	1030322	Black Evaporator Support
373	1030323	Black Cover, Flat, For Evaporator Support
374	1030386	Wiring PC Control Board
375	1030395	Black Knob to Secure Bowl
376	1030355	Control Board Mounting Plate, Black
377	1030351	PC Control Board 2 Bowl Models
378	1030948	Condenser Air Filter
379	1030949	Tray Top Black
386	1030359	Stainless Steel Right Side Panel
389	1030403	Main Fuse 20 A (115/60 Models Only)
390	1030982	Fuse
393	1030325	Auger, Granita One Piece
394	1030374	Light Support
400	1030352	Thyermister
405	1030951	Compressor Screen (115/60 Models Only)
406	1030358	Control Box Cover Black
408	1030952	Lock Hook
409	1030953	Control Panel Cover Lock
491	1030963	Transparent Plate
493	1030965	Back Advertisement
500	1030980	Double Sub Cover
502	1030964	Cover Locking Spring
503	1030999	Cover Locking Spring
506	1030995	Neon
507	1030996	Neon Hook
509	1030997	Starter
512	1030950	Knob, Back Panel
725	1030486	Scraping Washer
728	1030345	Bushing, Thrust Rev A, Bronze Shaft Guide
764	1030372	Dispensing Handle Black with Pin
784	1031013	Level Complete Probe L125mm
786	1031015	Safety Complete Probe L57mm
810	1030326	Shaft Seal, Rubber Bell Shaped
811	1030327	Seal Front Evap, New Style
858	1031028	Complete Shaft
859	1031017	Socket
906	1030979	Back Panel
970	1031016	Elbow 3/8
971	1031019	(PI011212S) Terminal



Internet: [www.bevcore.com](http://www.bevcore.com)  
Email: [custcare@bevcore.com](mailto:custcare@bevcore.com)  
Phone: 866-275-6392  
Fax: 866-329-6392

## ILLUSTRATED PARTS LIST

Item No.	Part No	Description
975	1031027	Shurflo Pump 5:1
976	1031014	(PI1212S) Connection
982	1030981	Double Electrovalve
989	1031026	Elbow M-F 3/8
992	1031020	Levels Card
994	1030983	Transformer
998	1031018	Spring Loaded
1117	1031022	Photo
1118	1031024	Photo
1119	1030962	Double Cover
1120	1031022	Photo
1121	1031023	Photo
1122	1031030	Double Cover Complete
1123	1030998	Reactor
1124	1031021	Photo