

**COMPRESSOR SERVICE REPLACEMENT KIT
P/N 629097597 (IMD 300-15, 115/60, ICE MAKER)
Installation Instructions**

Release Date: January 17, 2013

Publication Number: 629097597INS

Revision Date: December 3, 2019

Revision: A

Visit the Cornelius web site at www.cornelius.com for all your Literature needs.

The products, technical information, and instructions contained in this manual are subject to change without notice. These instructions are not intended to cover all details or variations of the equipment, nor to provide for every possible contingency in the installation, operation or maintenance of this equipment. This manual assumes that the person(s) working on the equipment have been trained and are skilled in working with electrical, plumbing, pneumatic, and mechanical equipment. It is assumed that appropriate safety precautions are taken and that all local safety and construction requirements are being met, in addition to the information contained in this manual.

This Product is warranted only as provided in Cornelius' Commercial Warrant applicable to this Product and is subject to all of the restrictions and limitations contained in the Commercial Warranty.

Cornelius will not be responsible for any repair, replacement or other service required by or loss or damage resulting from any of the following occurrences, including but not limited to, (1) other than normal and proper use and normal service conditions with respect to the Product, (2) improper voltage, (3) inadequate wiring, (4) abuse, (5) accident, (6) alteration, (7) misuse, (8) neglect, (9) unauthorized repair or the failure to utilize suitably qualified and trained persons to perform service and/or repair of the Product, (10) improper cleaning, (11) failure to follow installation, operating, cleaning or maintenance instructions, (12) use of "non-authorized" parts (i.e., parts that are not 100% compatible with the Product) which use voids the entire warranty, (13) Product parts in contact with water or the product dispensed which are adversely impacted by changes in liquid scale or chemical composition.

Contact Information:

To inquire about current revisions of this and other documentation or for assistance with any Cornelius product contact:

www.cornelius.com

800-238-3600

Trademarks and Copyrights:

This document contains proprietary information and it may not be reproduced in any way without permission from Cornelius.

This document contains the original instructions for the unit described.

CORNELIUS INC
101 Regency Drive
Glendale Heights, IL
Tel: + 1 800-238-3600

Printed in U.S.A.

COMPRESSOR SERVICE REPLACEMENT KIT

SAFETY



WARNING:

Before starting installation, read and understand all safety label and warnings on the machine. Also review and understand all safety instructions in the owners, installation and service manuals.

Failure to comply could result in serious injury, death or damage to the equipment.

QUALIFIED SERVICE PERSONNEL



WARNING:

Only trained and certified electrical, plumbing and refrigeration technicians should service this unit.

All wiring and plumbing must conform to national and local codes. Failure to comply could result in serious injury, death or equipment damage.

SAFETY PRECAUTIONS

This unit has been specifically designed to provide protection against personal injury. To ensure continued protection observe the following:



WARNING:

Disconnect power to the unit before servicing. Follow all lock out/tag out procedures established by the user. Verify all power is off to the unit before performing any work.

Failure to comply could result in serious injury, death or damage to the equipment.



CAUTION:

Always be sure to keep area around the unit clean and free of clutter. **Failure to keep this area clean may result in injury or equipment damage.**

These instructions describe how to install a replacement refrigeration compressor.

Unpack and inspect the kit. Make sure all parts listed are present and in good condition.

| Loose-Shipped Parts | | | |
|---------------------|-------------|---|------|
| Sl.No. | Part Number | Description | Qty. |
| 1. | 07153 | WSHR-FTT-A0505-0563-1375-109-ST-ZN | 4 |
| 2. | 100762 | NUT HEX 5/16-18 SSPA 312H | 4 |
| 3. | 168770002 | BOLT MA 5/16-18 HX 48 STZI | 4 |
| 4. | 620054543 | BASE COMP KIT RST64 | 1 |
| 5. | 620056174 | BOX CARTON 21 X 19 X 22 COM KIT IMD600-90A | 1 |
| 6. | 620056291 | PAD SCORED SLOTTED 21 X 12 X 10.5 COMP KIT IMD600-90A | 1 |
| 7. | 620056292 | PAD SCORED SLOTTED 15 X 20 X 10 COMP KIT IMD600-90A | 1 |
| 8. | 620062997 | COMP 1/3HP 120/60 TCMSEH 134A | 1 |
| 9. | 620065177 | DRYER ASY IMD300/15 | 1 |
| 10. | 620065178 | TUBE SUCTION LINE ASY IMD300/15 | 1 |
| 11. | 620065179 | TUBE SUCTION IMD 300/15 | 1 |
| 12. | 620065180 | TUBE DISCHARGE IMD 300/15 | 1 |
| 13. | 638032817 | LABEL WIRING DCF-15 | 1 |
| 14. | 620072543 | LABEL COMP REPLACEMENT IMD300/15 | 1 |
| 15. | 620072544 | LABEL COMP REPLACEMENT EXTERNAL IMD300/15 | 1 |

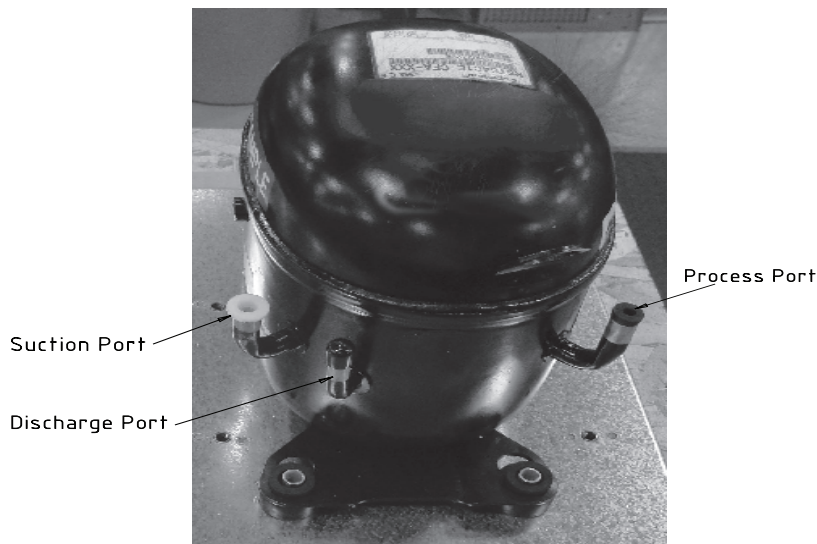

Figure 1. New Compressor with Grommets

REPLACEMENT COMPRESSOR

1. Remove the electrical connections from the existing Compressor E-Box and remove the existing Compressor cable.
2. Remove the existing Compressor E-Box from the centre panel as shown in Figure 2.
3. Remove the TXV bulb from the location without damaging the TXV capillary.
4. Debraze the tubings from low side and discharge side then disassemble and remove the existing compressor as per established procedures in handling refrigerants.

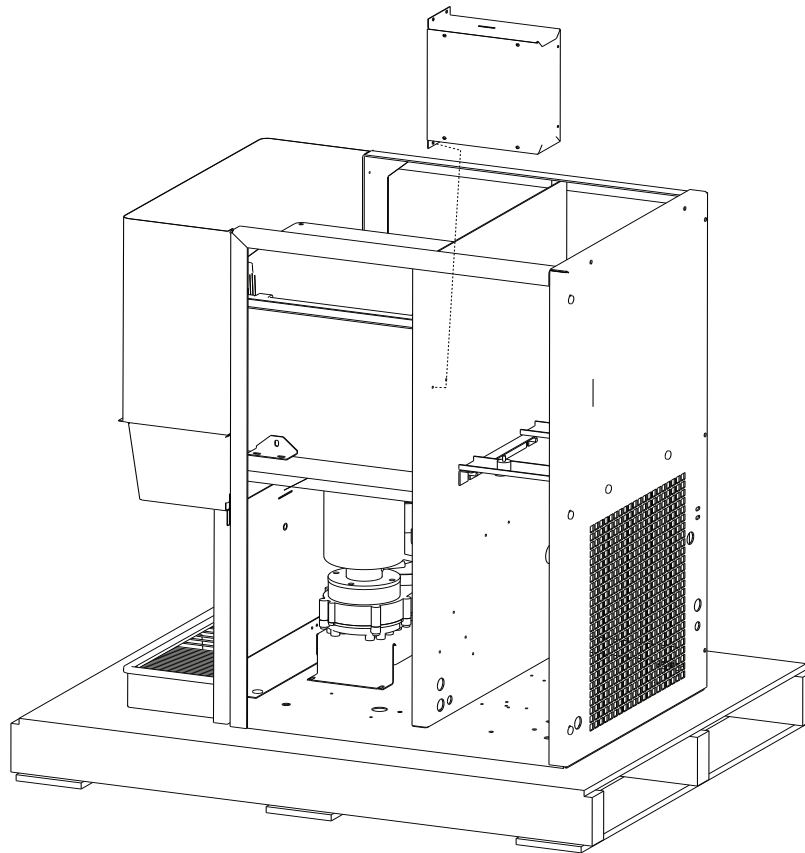

Figure 2. Removing the existing E-box.

5. Put the Label 620072543 on the new Compressor, just above the seam. Refer Figure 3.

THIS SEALED UNIT HAS BEEN CONVERTED TO USE
COMPRESSOR MODEL AE24I3Y-AAIB THE NEW
REFRIGERANT CHARGE IS 12 OUNCES OF R134A.

Figure 3. Compressor Sticker

6. Position new compressor with grommets on the mounting bracket and secure using bolts, washers.

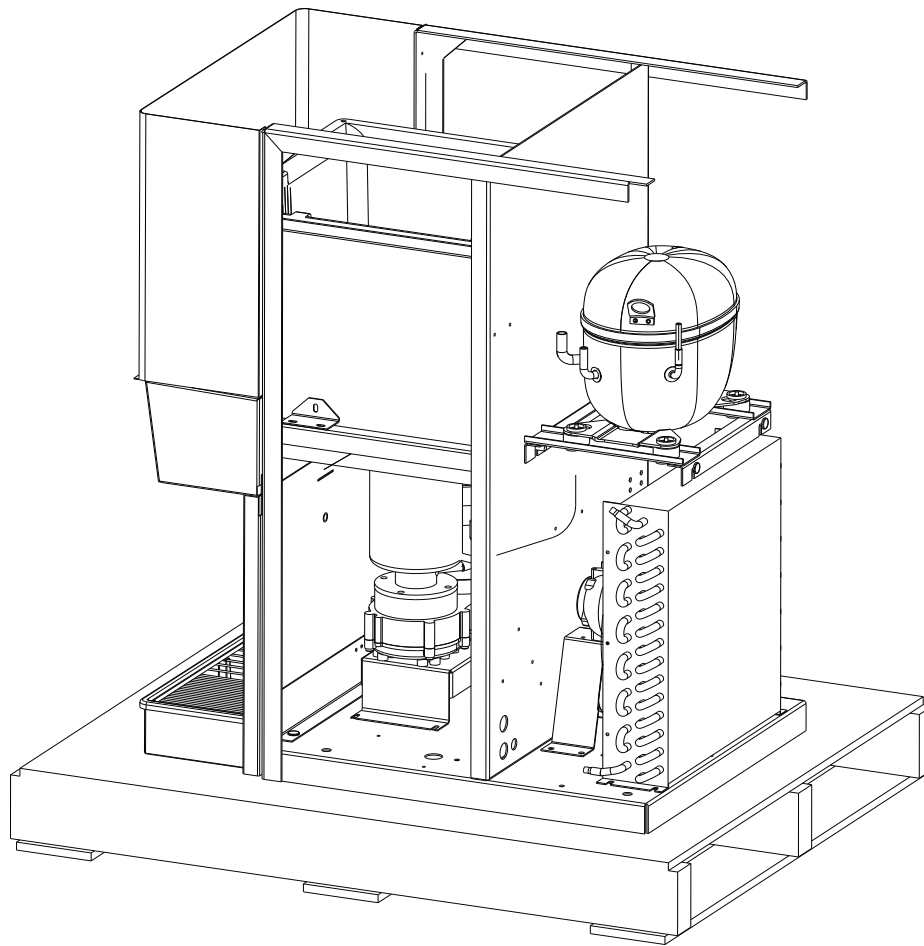

NOTE:
BACK PANEL NOT SHOWN

Figure 4. Schematic showing the orientation of the New Compressor

7. Release the Nitrogen from the Compressor. Connect the Discharge tube as shown in Figure 5.

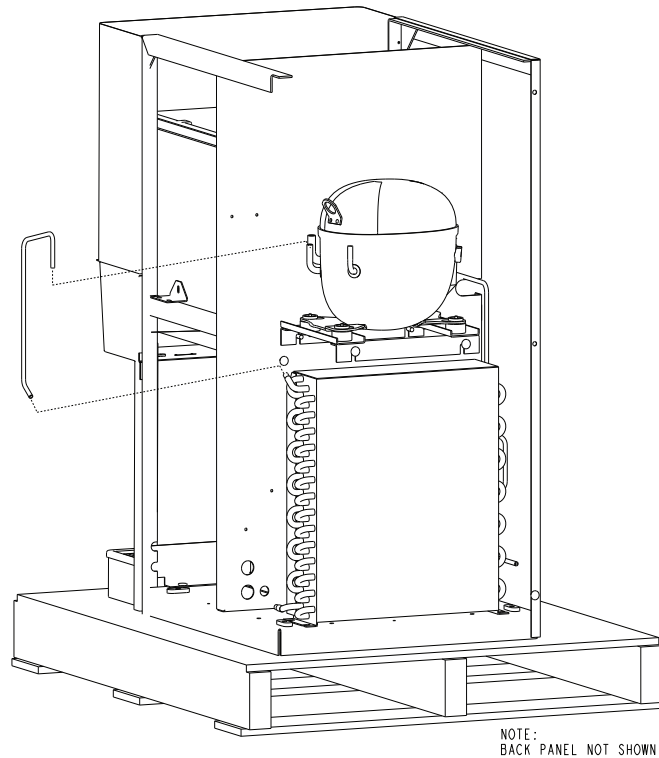

Figure 5. Connection of Discharge Tube

8. Connect the Dryer assembly as shown in Figure 6.

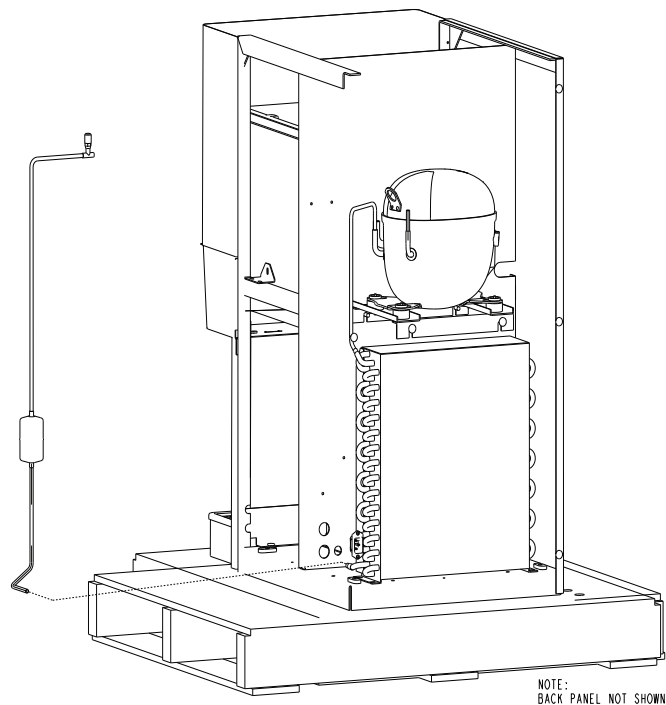

Figure 6. Connection of the Dryer assembly

9. Connect the Suction HX assembly as shown in Figure 7.

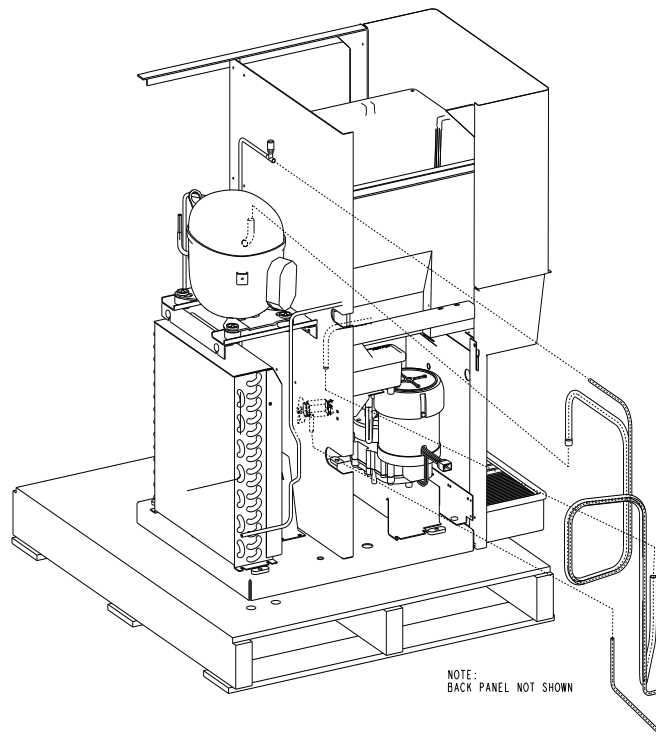

Figure 7. Connection of the Suction HX assembly

10. Braze the joints, evacuate and charge with refrigerant per established procedures in handling refrigerants. Make sure that TXV Bulb is not placed on Brazing bead/seam. Mount the TXV bulb in 12° Clock position and wrap it firmly with the copper tube.
11. Insulate the suction line assembly and TXV.
12. Install the compressor E-box mounting bracket on to the centre panel as shown in Figure 8. using rivets.

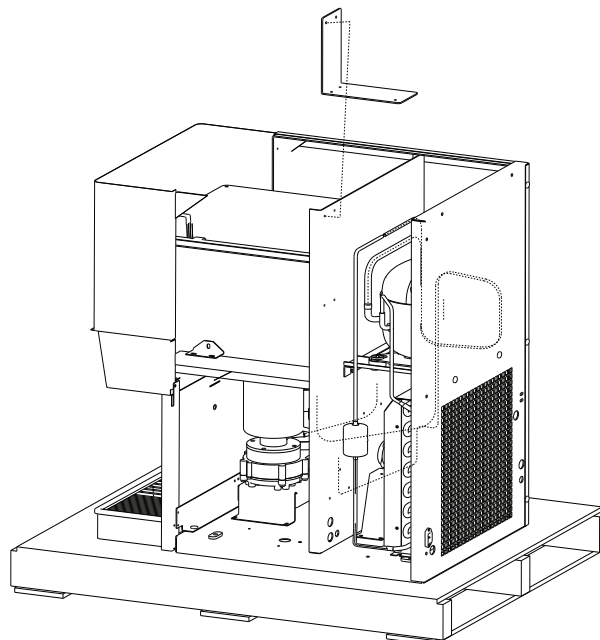

Figure 8. Installing Compressor E-box mounting bracket

13. Install the new compressor E-Box on the mounting bracket. Refer Figure 9.

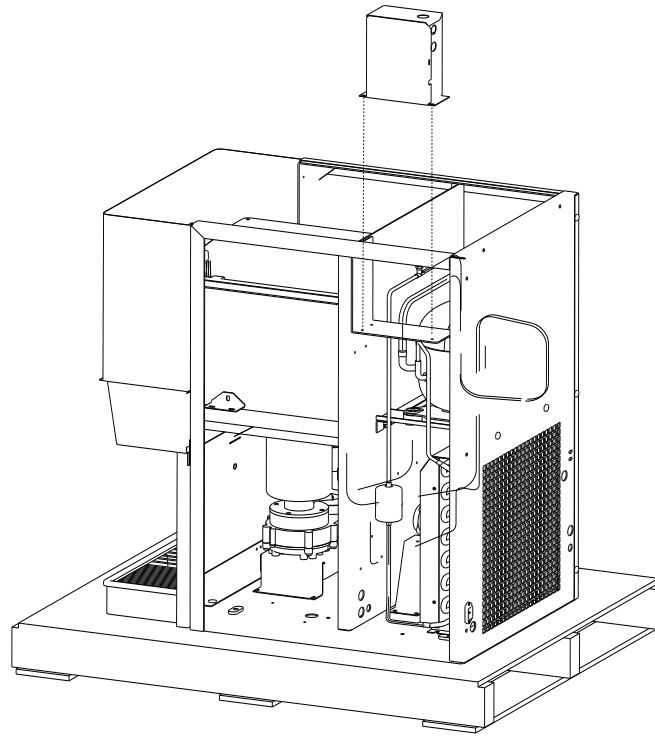

Figure 9. Installation of New Compressor E-Box

NOTE: Ensure that all electrical components i.e Compressor, Condenser Fan Motor, Compressor E-Box and Control E-Box are properly grounded according to Federal, State and Local laws.

14. Ensure all the Tubings are placed as shown in Figure 10.

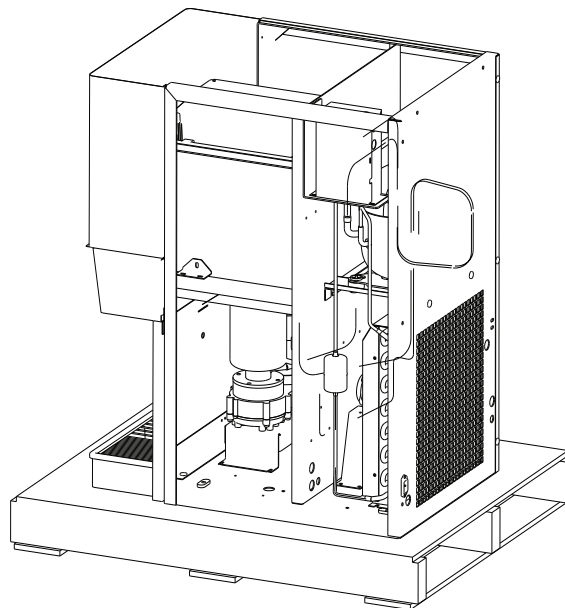

Figure 10. Refrigeration Assembly

15. Make sure all electrical connections are properly connected.
16. Connect electrical power and confirm proper operation.
17. Put the label 620072544 on the back panel below the serial label. Refer Figure 11.

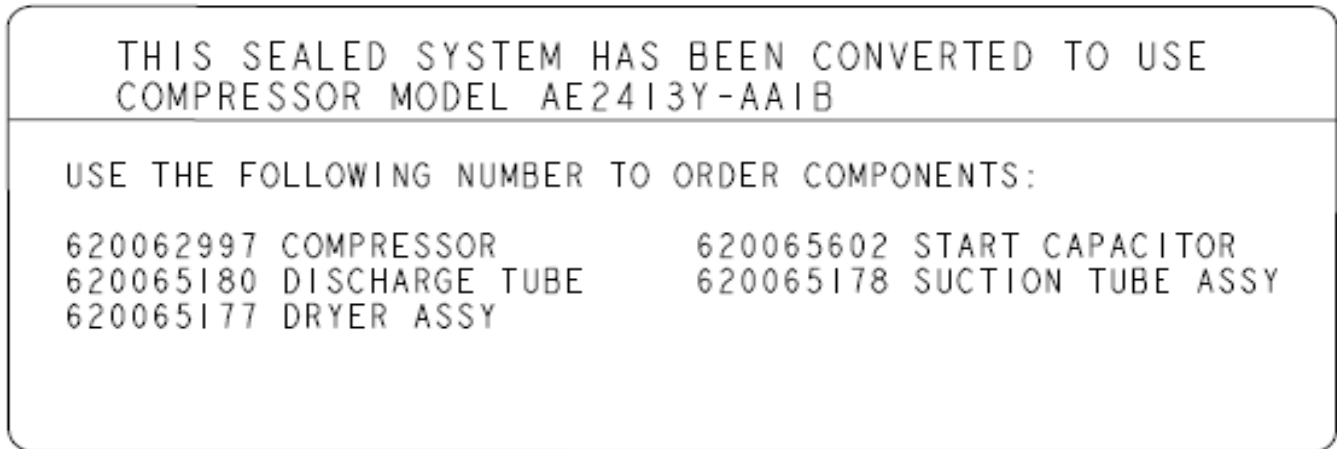

Figure 11. External Label

